

Locus L 9655	Dor 19 9.1	Fld G.	Sq A.K.33	Loc. type pit
Open	Date 12/07/91	High 14.62	at NW	Low at
Close	15/07/91	14.41	SE	
Floor: type				
Length 2.0	Width 1.5	Vol		
Value d	Remove 15/07/91	Drawn? YES		
Photo #(1)		Photo #(2)		Loci L9633 L9644 L9603
Written by: JMS		Checked by: JAZ		above
				below

Unit	Phase	Stage	Stratum	PoM
------	-------	-------	---------	-----

Summary

Opened: When material of grey, ashy matrix beneath [L9633] was collapsed with similar pit material beneath [L9644] and [L9603].

Limits (N) Bounded by the material beneath [W9510] and [L9634] to the North (unnumbered)

(S) Bounded by [L9668] to the South and by [L9042], excavated '86 season

(E) Bounded by [L9302] ('88 season) to the East in SQ A533.

(W) Bounded by [L9662] and [L9668] to the W.

Closed: When pit material was removed to reveal mudbrick material beneath [L9679].

Matrix: Loose, grey ashy material with many sherds, bones, and some bits of charcoal.

Relations: [L9655] is covered by [L9633], of which it is the extension, by [L9644] which also cuts [L9655], and cleaning locus [L9603]. [L9655] is cut and sealed by [L9644] which is the foundation trench for [W9510], which therefore also cuts [L9655]. [L9655] reaches pit [L9634], although pit [L9633], of which [L9655] is the continuation, does cut pit [L9634]. [L9655] cuts the NE corner of [L9679] and covers [L9679] in that area. [L9655] cuts [L9668] and [L9662].

Additional Observations/Value: Persian pit cut by large wall [W9510], while cutting fallen Iron Age mudbrick material beneath.

Locus Basket List

L 9655

Bask. No.	Sq.	Beg. Ele.	Clb. Ele.	St Df	Lc Ob	Ma	R	C	Pi	P2	P3
98307	AK33	14.82	14.55	pt	sh cr	z	d	pr		ir2c	
ATC; top of Lekythos.											
98308	AK33	14.82	14.55	pt	ma bn		d				
98348	AK33	14.85	14.41	pt	sh cr	z	d	pr		ir2c	
ATC; EGR, BIC; one black figure. Mostly Iron Age. Levels for 15/07/91 are suspect; transit knocked out of alignment.											
98349	AK33	14.85	14.41	pt	ma bn		d				
Levels for 15/07/91 are suspect; transit knocked out of alignment.											
98384	AK33	14.85	14.41	pt	ma ir		d				
Iron frag. Levels for 15/07/91 are suspect; transit knocked out of alignment.											

LOCUS
L 9655

Sketch plan

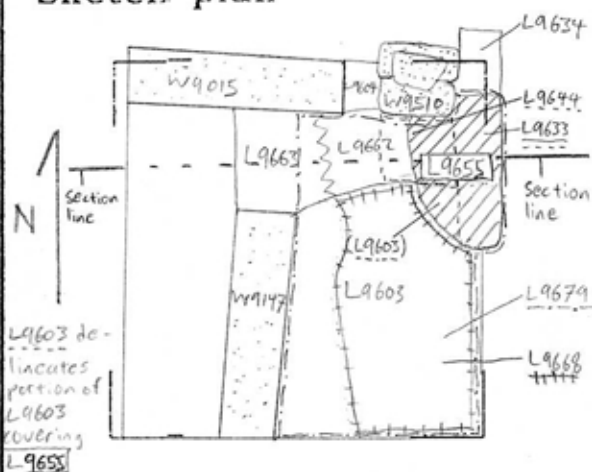

L9603 delineates portion of L9603 covering L9655

*Note: the border between L9663 and L9662 was never clearly defined, but rather existed over a wider spectrum.

Photo

Photo

Section

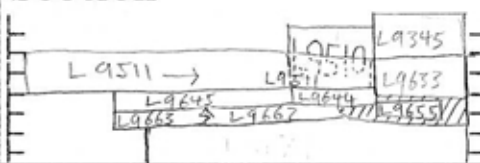

Section

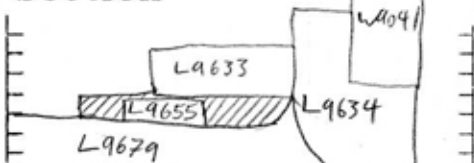

*Note: it is impossible to show the relationship between L9655 and L9603 in this 2.0 fo