

Locus L 9,6,8,2	Dor 19 9.1	Fld .6	Sq A.I,3,4, , , , ,	Loc. type Robber Trench or Fill		
Open	Date 1.8/07/91	High at 1.5 · 1.5	at N.W	Low at 1.5 · 1.0	at S.E	Seals: _____
Close	Date 2.3/07/91	High at 1.5 · 0.9	at N.E	Low at 1.5 · 0.1	at N.W	Sealed by: _____
Floor: type	_____	_____	_____	_____	_____	Loci 9,6,5,2, 9,6,5,1, _____
Length 2.1.6	Width 0.7	Vol _____	_____	_____	_____	above _____
Value ?id	Remove 2.3/07/91	Drawn? No.	_____	_____	_____	below _____
Photo #(1) _____	Photo #(2) _____	_____	_____	_____	_____	Loci 9,6,3,8, _____
Written by: K.A.K	Checked by: J.R.Z	_____	_____	_____	_____	below _____

Unit _____	Phase _____	Stage _____	Stratum _____	PoM _____
------------	-------------	-------------	---------------	-----------

Summary

Opened: Opened [L9682] to investigate and define material in robber trench/fill area surrounding parallel ashlar drain.

Limits (N) L9616 L9695
(S) L9680 L9681
(E) L9697
(W) L9696 W9085

Closed: Closed [L9682] when determined parallel ashlar are southern limits of drain 9698 by excavating north L9616 and L9695 level with [L9682] and finding NS continuation of drain.

Matrix: [L9682] contained fine, bleached brown light soil with pottery, shell, and kunkar fragments typical of robber trench or fill material. [L9682]'s soil was lighter and less dense with pottery than pit 19681, and similar in texture but less dense with fragments than pit 19680. [L9682]'s material resembles north fill and trench material in L9616 and L9695 because these are the same matrix. At NW, the ashlar emerging out of L9695 measures .60m x .40m, and the ashlar in t

(Relations): NE measures .33m x .44m (the length is still half covered). Additional worked stones in NE-most corner included a stone "spit" of material .71m x .13m.

[L9682] cuts pit 19681 at the SE which contains only Persian and Iron Age sherds. [L9682] reaches pit 19680 at the SE - a more precise relationship being unclear as they contain similar pottery. To the west, [L9682] reaches L9696 which may be a section of a NS robber trench making a corner with W9085's re-used column drum. [L9682] is a continuation of the fill and robber trench loci north: L9616 and L9695. It was dug separately to investigate a proposed E-W robber trench robbing W9085. However, excavation has shown that [L9682] is the meeting area for several robbing actions surrounded by fill, including: NS (9616 and 9652) robbing drain 9698 and E-W (9617 and N. 9697) robbing W9292. To the west of [L9682] was L9697 ^{which} the western continuation of W9292 from A13d was discovered. This northern portion of L9697 may be the robbing material from W9288 and the trench may cut the eastern portion of [L9682]. The sequence of robbing actions is unclear, as is the relation of the worked stones and kunkar spit in the NE corner of [L9682] to drain or any other feature in A13d.

[L9682] recovers the NE portion of pit 19651 that L9652 had lost. [L9615, L9652, and L9682] are the same fill material, it is unclear that the NE spit of pit 19651 would intrude into the fill, but that is how it appeared when excavating.

Additional Observations/Value: [L9682] is a disturbed meeting area for several robbing actions. Of little value except that top of drain 9698 revealed here.

Locus Basket List

L 9682

Bask. No.	Sq.	Beg. Ele.	Clc. Ele.	St Df	Lc St	Ob	Ma	R	C	P1	P2	P3
96590	AI34	15.01	15.01	rt		sh	cr			u		
Ceramic lid.												
96591	AI34	15.10	15.05	rt		sh	cr	2		u	pr	
1 ir2c.												

Locus

L 9682

Sketch plan

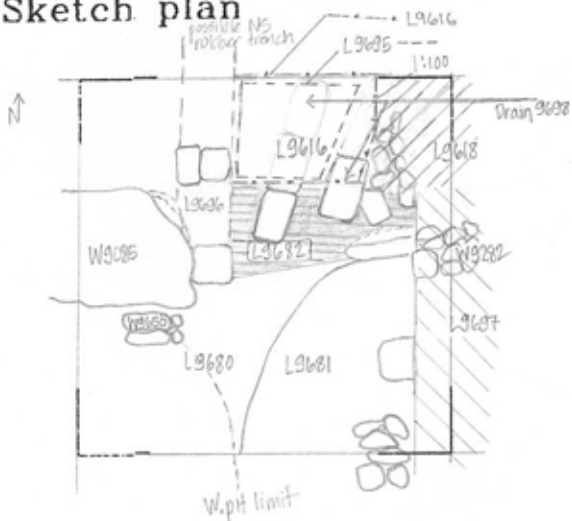

Photo

Photo

Section

Section