

Locus W9684	Dor 19 91	Fld 6	Sq A.133	Loc. type Wall
Open	Date 1/7/07/91	High at 15.52 M	Low at 15.17 S	Seals: _____
Close	0/7/08/91	14.38 S	14.36 N	Sealed by: _____
Floor: type				Loci 9643 9278 9096 9666
Length 3.5	Width 0.5	Vol		above _____
Value 1	Remove	Drawn? YES		below _____
Photo #(1)		Photo #(2)		
Written by: RSS		Checked by: JRZ		

Unit	Phase	Stage	Stratum	PoM
------	-------	-------	---------	-----

Summary

Opened: L9643 divided into W9684 and E. half of L9667 when L9643 came down on walk

Limits (N) Continues .90m into AE34

(S) Ends on fill below W9096

(E) L9298, L9674, L9687, L9693, L9699, L9722, L9734, L9717 and L9708

(W) L9667, W9694, L9692, L9723, W9729, L9726 and L9731.

Closed: End of season - Not closed

Matrix: Double-headed size cobbles, identical to W9266. Several smaller (fist-size) cobbles embedded into matrix. In AE34, W9684 surrounded at west, north and east by mudbrick: one course exposed (top level 15.48, bottom level 15.11)

Relations: L9643, L9666 and below W9096 cover W9684.

W9278 was built on top of and perpendicular to W9684.

To the W. L9667, L9674, L9692, L9723, L9726 and L9731 reach L9684.

To the E. L9298, L9674, L9687, L9693, L9699, L9722, L9724, L9717 and L9708 reach W9684. To the S., W9684 dovetails

into the fill below W9096. The S. end of W9684 dovetails

with the W. extension of W9729. W9729 probably continues

E. of W9684 until it abuts W9266, though this relationship

is obscured by the fill below W9096 covering the connection.

W9684 runs parallel to W9266 to the E. and is almost

certainly related to this wall. Both are probably E and W. walls

to a room. Six courses were uncovered this season, and

W9684 is still continuing down. W9684 continues north into AE34 for .90m

and is reached at west, north, and east by mudbrick. L9683 is cut by pit L9681.

Additional Observations/Value: Wall which dovetails with W9729 and is a "sister" wall to W9266.

Locus Basket List

W 9684

Bask. No.	Sq. Comments	Beg. Ele.	Clo. Ele.	St Df	Lc Ob	Ma	R	C	Pi	P2	P3
96592	AI33 Cleanig material from west face of wall.	15.58	15.18	ci	sh cr	0	u	ir			
96841	AI33	15.58	15.12	ci	sh cr	0	u	ir			

LOCUS
W 9684

East At 19681

Sketch plan



Photo

Photo

Section

Section

(entered)

Locus W9684	Dor 1992	Fld 6	Sq A133	Loc. type Wall card 2
Open 14/07/92	High 15.58	at N	Low 15.17	at S
Close 14/08/92	13.45	N	13.06	S
Floor: type	Width	Remove	Vol	Drawn? YES
Length 3.5	0.5			
Value 1				
Photo #(1) 86289	Photo #(2)			
Written by: RSS	Checked by: JRZ			
Seals: _____	_____	_____	_____	_____
Sealed by: _____	_____	_____	_____	_____
Locl above	_____	_____	_____	_____
Locl below	_____	_____	_____	_____

Unli	Phase	Stage	Stratum	PoM
------	-------	-------	---------	-----

Summary

Opened: continued excavating E + W of W9684.

Limits (N) EXCAVATE BULK FROM 15.00 - 14.54 IN 1992 - NO RELATIONS

(S) See previous season card.

(E) L9759, L9817, L9828, L9830 and L9831; L9769, L9771, L9811, L9838

(W) L9755, L9808, L9816, L9835, W9841 and L9844; L9754, L9780, L9789, L9777, L9801

Closed: Not closed - End of season.

Matrix: Approximately 10 courses seen. At least two building phases - Earlier phase used large double or triple head sized boulders while later phase used mostly head sized boulders. Number of courses in earlier phase is four to five and in the later phase approximately four.

Relations: L9759, L9817, L9828, L9830 and L9831 reach the E. face of W9684. To the W. L9755, L9808, L9816, L9835 and L9844 reach the W. face of W9684. W9841 abuts against the W. face of W9684. It is becoming apparent that W9684 is a three phase and possible four phase wall. The earliest phase relates to the 12th century destruction noted to the S. in A132. The foundation for W9684 clearly goes into this destruction (see W9841 card) - whether the foundation was simply built into the destruction or whether W9684 was a wall which stood pre-destruction is uncertain. The next phase relates to the destruction which preserved the human skeleton in the rubble covering W9841. This rubble apparently fell from W9684 and an unknown wall in the bulk of A134 (probably W9211). The floor for this phase is 9816. Floor 9759 and 9817^{to the E} may be either the same period or slightly later. There was also probably a floor at the upper level of the rubble L9816 which was not preserved (approx. 14.30). Two higher floor fragments are preserved E. of W9684 - floors 9687 and 9693. A final phase may have been with the series of floors at the base of L9828. The floors which appear to reach W9684 are F9828, F9817 and F9816.

TO EAST, AT NORTH END, W9684 IS REACHED BY L9769, L9771, L9811, & L9838

TO WEST, AT NORTH END, W9684 IS REACHED BY L9754, L9780, L9789, L9777, & L9801, not reached by F9754

Additional Observations/Value: Very tall Iron Age wall - Very valuable.

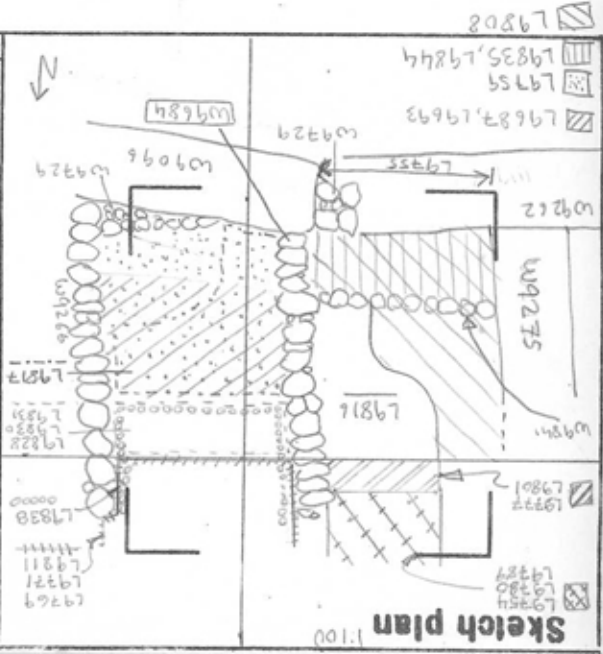
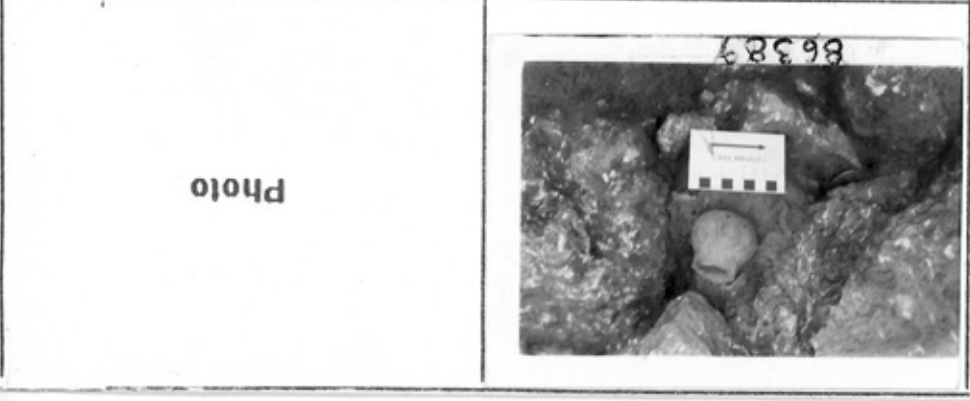
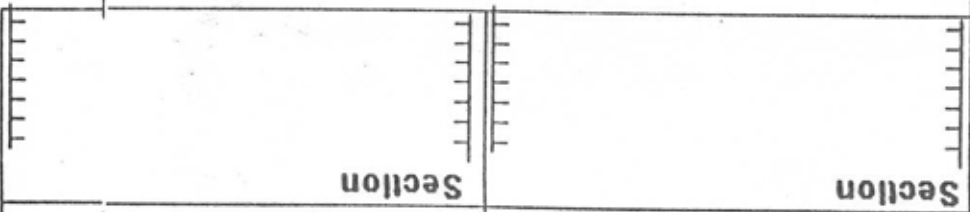

Locus W9684	Dor 1993	Fld G	Sq A1B3	Loc. type WALL CARD #3-B EAST
Open	Date 02/07/93	High at 15.58 N	Low at 15.17 S	Seals: _____
Close	06/08/93	13.51 N	13.50 S	Sealed by: _____
Floor: type	_____	_____	_____	Locl CHECK PREVIOUS SEASONS CARDS
Length 3.8	Width 0.6	Vol _____	_____	above _____
Value _____	Remove _____	Drawn? YES	_____	below _____
Photo #(1) 10148	Photo #(2) 100751	_____	_____	Locl UNEXCAVATED
Written by: SSR	Checked by: JAZ	_____	_____	_____

Unit	Phase	Stage	Stratum	PoM
Summary				

Opened: CONTINUED EXCAVATION AT BEGINNING OF SEASON

Limits (N) W9211, ALSO SEE PREVIOUS SEASONS' CARDS

(S) SEE PREVIOUS SEASONS' CARDS

(E) L9855, L9896, L9937, L9994, AND SEE PREVIOUS SEASONS' CARDS

(W) SEE PREVIOUS SEASONS' CARDS.

Closed: NOT CLOSED - END OF SEASON

Matrix: AT LEAST A TWO PHASE WALL, WITH THE UPPER PHASE CONSISTING OF DOUBLE FIST TO HEAD-SIZE FIELDSTONES AND THE LOWER PHASE CONSISTING OF HEAD-SIZE TO TRIPLE HEAD-SIZE FIELDSTONES. IT IS SIMILAR TO W9266. THERE ARE 9 EXPOSED COURSES ON THE EAST SIDE OF THE WALL. WALL IS NOT YET FLOATING.

Relations: W9211 ABUTS W9684. THE RELATIONSHIP BETWEEN W9684 AND THE MUDBRICK PHASE OF W9729 REMAINS UNCLEAR. THE REMOVAL OF W9096 AND THE FILL BELOW WOULD EXPOSE THE EAST SIDE OF W9729 AND CLARIFY THE CORNER WITH W9684.

W9684 IS REACHED BY L9855, L/F9876, L/F9937 (IN ONLY ONE PLACE) AND L/F9994. F9876 NOT ONLY REACHES W9684, BUT W9211, W9729, W9845 AND W9266 AS WELL. F9937 REACHES W9684 IN THE S/W CORNER. F9994 ALSO REACHES THIS CORNER, BUT THE REMAINDER OF THIS FLOOR WAS NOT TRACED AT THE END OF THE SEASON.

ALSO, CHECK PREVIOUS SEASONS' CARDS.

Additional Observations/Value: VERY VALUABLE IR WALL; Reached by many floors!

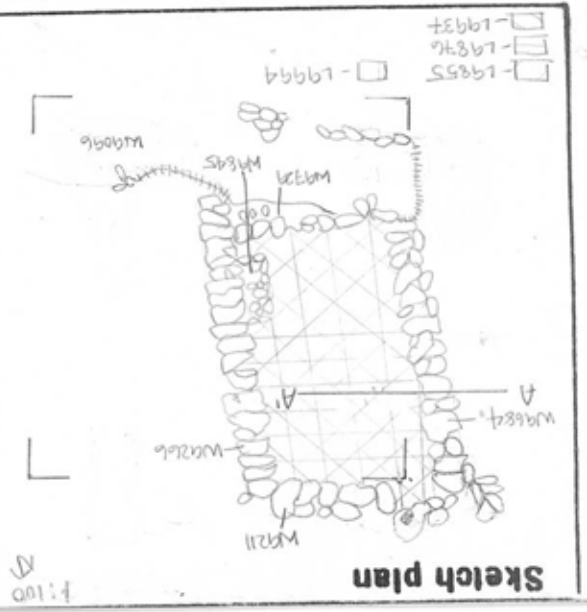
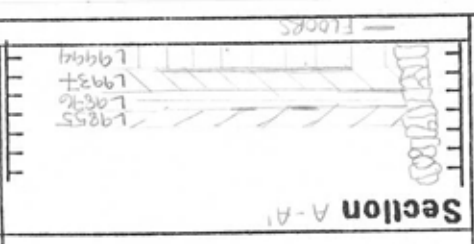
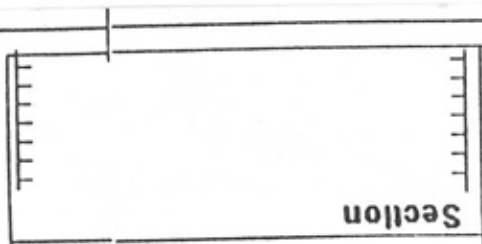

external

Locus WJ 9684	Dor 19 93	Fld G ₁	Sq A 133/34	Loc. type <u>Wall Card 3a (west)</u>
Open	Date <u>02/07/93</u>	High at <u>15.58 N</u>	Low at <u>15.17 S</u>	Seals: <u> </u> <u> </u> <u> </u> <u> </u>
Close	<u>04/08/93</u>	<u>13.10 N</u>	<u>12.90 S</u>	Sealed by: <u> </u> <u> </u> <u> </u> <u> </u>
Floor: type <u> </u>	Width <u>0.5</u>	Vol <u> </u>	Drawn? <u>YES</u>	Locl above <u> </u> <u> </u> <u> </u> <u> </u>
Photo #(1) <u>See/sra</u>	Photo #(2) <u> </u>			Locl below <u> </u> <u> </u> <u> </u> <u> </u>
Written by: <u>RSS</u>	Checked by: <u>JR2</u>			

Unit	Phase	Stage	Stratum	PoM
------	-------	-------	---------	-----

Summary

Opened: Wall continuation

Limits (N) _____

(S) _____

(E) _____

(W) See previous season cards plus L9816, L9926, L9927, L9928, L9919, L9955, L9866, L9872, L9971/11, W9961, W9211 + W9262

Closed: Not closed - End of season.

Matrix: See previous season cards - Now 11-12 courses high.

Relations: For all previous relations see 1991 and 1992 cards. See also 1992 card for summary of first and second phases of wall.

To the w. L9866, L9872, L9816, L9926, L9927, L9928, L9919, L9955 and L9971 all reach the west face of W9684.

L9816 is a continuation of Doreen's rubble fall and reaches the second phase of W9684. F9816 also presumably reached this phase.

F9928 climbs sharply as it approaches W9684 and reaches an hypothesized third phase (no clear difference in building material or method was seen.)

F9927 also probably reaches to this third phase, while F9955 clearly reaches W9684 at this phase. F9971 is a third phase floor which probably reached rocks abutting W9684. This is part of the wine press installation (along with F9928). This installation may have been the original use of the room walled by W9684.

W9961 abuts W9684. W9961 appears to abut W9211 to the N. There is a clear seam along which the two walls meet. W9262 (phase D - lowest stone visible) clearly dovetails with the third phase of W9684. Several small (double fist size) stones of the scale are built into the matrix of W9684 and the two walls make clear dovetailed corner.

Additional Observations/Value: Very high value.

