

Locus L 9691	Dor 1991	Fld G.	Sq A.I.3.2	Loc. type Cleaning locus, down to wall
Open Date 2.2.07.91	High at 14.20 E	Low at 14.14 W	Seals: _____	
Close Date 2.5.10.7.91	13.99 NE	13.97 SW	Sealed by: _____	
Floor: type L.L	Width 0.8	Vol _____	Loci above _____	
Value d	Remove 2.5.10.7.91	Drawn? N.O.	Loci below _____	
Photo #(1)	Photo #(2)			
Written by: <u>BAT</u>	Checked by: <u>JRZ</u>			

Unit	Phase	Stage	Stratum	PoM

Summary

Opened: To remove soil wash caused by erosion since 1989 season

Limits (N) Bordered by [L9530] & [L9553]

(S) Bounded by [L9686]

(E) Bordered by [W9626] & [L9661]

(W) Bounded by [L9259]

Closed: Came down on mudbrick wall [W9704]

Matrix: mudbrick debris, small amount of pottery & some bones; special find was a grinding stone

Relations: Since [L9691] is a "cleaning" locus, some of its relations are uncertain. [L9691] covers, but does not seal, mudbrick wall [W9704]. To the N, the material of [L9691] seems similar to the material of [L9530], described as fill, partly of mudbrick debris. [L9530] was not, however, fully excavated by the end of the 1989 season, and was taken down only to ca. 14.23. But by the beginning of the 1991 season, there had been noticeable erosion in this area. [L9553] was described as fallen bricks/mudbrick debris which possibly reached [L9530] ("but this is uncertain"). To the S, the relation between [L9691] & [L9686] is uncertain, since both are "cleaning" loci. To the E, the relation between [L9691] & [W9626] is uncertain; but [L9691] may reach [W9626], since the former may be debris actually fallen from the wall itself. To the W, the material of [L9691] may be identical to that of [L9259], described as mudbrick fill and rubble.

\*[L9553] is also described as collapse from [W9295], excavated mainly to W of the area.

The NW corner of [L9661] reaches mudbrick wall [W9704] below [L9691].

Additional Observations/Value: Although a cleaning locus, the material from [L9691] was mainly Iron Age.

Locus Basket List

L 9691

Bask. No.	Sq.	Beg. Ele.	Cl. Ele.	St Df	Lo St	Ob	Ma	R	C	P1	P2	P3
98882	AI32	14.20	13.97	ns	sh	cr	0	n	ir		pr	
98785	AI32	14.01	13.99	ns	sh	cr	0	n	ir			
98787	AI32	14.01	14.01	ns	tw	st			n			
Grindstone.												
98789	AI32	14.01	13.99	ns	ma	bn			n			

Locus  
L 9691

Sketch plan

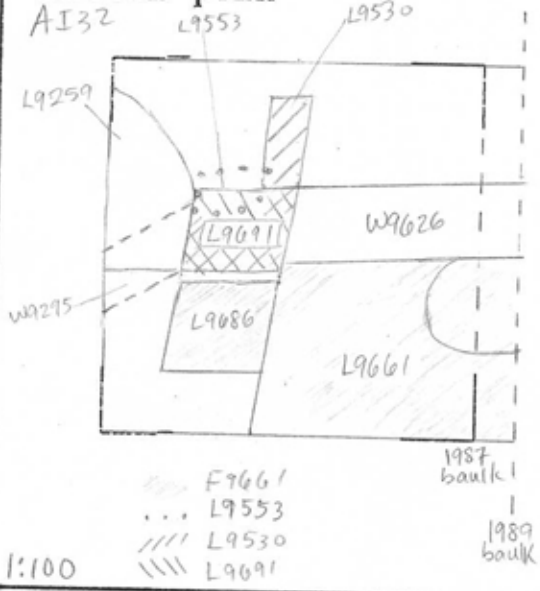

Photo

Photo

Section

Section