

Locus W 9728	Dor 19 9.1	Fld G ₁	Sq A.I.32	Loc. type mudbrick wall and stone socle		
Open	Date 06/08/91	High 14.39	at N ₁	Low 14.28	at S ₁	Seals: _____
Close	08/08/91	13.95	N ₁	13.95	S ₁	Sealed by: L9685
Floor: type	_____	_____	_____	_____	_____	Loci L9713 L9685
Length 1.6	Width 0.8	Vol _____	_____	_____	_____	above _____
Value 15	Remove 1/1/1	Drawn? Y,ES	_____	_____	_____	below _____
Photo #(1) #71377	Photo #(2) #71378	_____	_____	_____	_____	_____
Written by: RAIT	Checked by: J.R.Z	_____	_____	_____	_____	_____

Unit	Phase	Stage	Stratum	PoM
------	-------	-------	---------	-----

Summary

Opened: In excavating [L9685], came down on mudbrick material, and in taking down [L9713] to the S, came down on stone socle; opened [W9728]

Limits (N) Bounded by N bank of A132

(S) Bounded by [W9626]

(E) Bordered by [L9712]

(W) Bordered by [L9733] and [L9730]

Closed: End of Season; Not closed

Matrix: Crumbly dark-brown and rust-colored mudbrick material, faint traces of a fug-line visible on E face near N bank; atop a stone socle of three visible (thus far) courses double-fist to head-sized stones

Photo #(3) #71379; #(4) 71380

Relations: [L9685] covers and seals the part of [W9728] that lies below [F9685]. [L9713] covers, but does not seal, the part of [W9728] that lies below [L9713]. [W9728] seals the as-of-yet unnamed loci below it. Until [W9728] is removed, its relation to these loci is unknown. To the N, [W9728] reaches the N bank of A132. To the S, [W9728] abuts [W9626] forming a corner at [W9728]'s S end. Only the stone socle is preserved at the S end of [W9728]. The relation between [W9728] and [W9704] is uncertain until further excavation. Thus far, these walls have not been excavated further down than their stone socles in this area. To the E, the fill of [L9690] and [L9640] probably reach [W9728]. These fills are described as mudbrick debris, and may represent collapse from [W9728] itself. [F9690] reaches [W9728]. Also to the E, the fill of [L9712] reaches [W9728]. The relation between [W9728] and [F9712] is uncertain, because the floor could not be traced with certainty as reaching the wall; [F9712] may be cut by [W9728], or else⁹⁷²⁸ may float above it. To the W, [L9733] and [L9730] reach [W9728], and may contain debris collapse from the wall itself.

Additional Observations/Value: [W9728] seals the material below, and therefore has high value.

LOCUS

W 9,7,2,8

Sketch plan

AI32

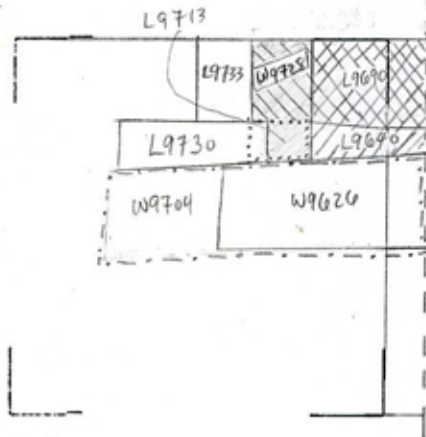

- W9704
- \\ L/F 9685 (above)
- // L/F 9712
- ... L9713

1:100



Locus W 9728	Dor 19 9,2	Fld G ₁	Sq AI32	Loc. type Card 2 mudbrick wall and stone socle
Open 09/07/92	High 14.56	at C ₁	Low 14.19	at S ₁
Close 14/08/92	High 13.80	at C ₁	Low 13.78	at S ₁
Floor: type _____	Width 0.7	Remove ___/___/___	Vol	Drawn? YES
Photo # (1) 86792 87005	Photo # (2) 86793	Locl 9779 9732		
Written by: RMT	Checked by: JRZ	above _____		
		below _____		

Unit	Phase	Stage	Stratum	PoM
Summary				

Opened: See card 1

Limits (N) See card 1 for Limits

(S) _____

(E) _____

(W) _____

Closed: End of Season - Not Closed

Matrix: Stone socle of W9728 is preserved to 6 courses on the Eastern face (14.15 - 14.14, top of socle; 13.75 - 13.60 bottom), 6 courses on Western face (14.15 - 14.07, top; ca. 13.75, bottom); mudbrick preserved to ca. 4 1/2 courses in center of wall, tapering to less than 1 at either end (14.29 N, 14.56 Cen 14.19 S)

Relations: L9770 covers but does not seal W9728.

To the North, L9732 reaches W9728, and is probably, in part, debris from it. W9262 forms a corner with W9728, and may be detailed with it. This is uncertain until further excavation.

To the South, the relation between W9728 and W9704 remains uncertain. The mudbrick courses of W9728 definitely float above W9704; the stone socle of W9728 appears to abut rather than cut W9704.





To the East, the fill of L9775 reaches W9728; F9775, however, is very fragmentary and could not be traced as reaching W9728. L9787 appears to reach the socle. Also to the East, the fill of L981 reaches W9728. F9813 reaches the socle W9728. If so, this contradicts the conjectured relation of F9814 to W9728 to the west (see below). L/F9834 reach the socle of W9728.

To the West, L9776 and L9807 below it, reach W9728, and are probably, in part, debris from it. The fill of L9814 reaches the socle W9728; F9814 could not be traced as reaching W9728. F9814 is at about the same level as F9712 to the East of W9728. The 1991 locus card for L9712 states that the floor could not be traced as reaching W9728, and suggested that W9728 may have cut F9712. Therefore, it is possible that F9814 is cut by W9728. It is unlikely, however, that W9728 cuts F9712 and is reached by F9814; unless F9813 and F9814 pertain to the same phase at different levels. In this case both F9813 and F9814 could reach W9728 while F9712 is cut.

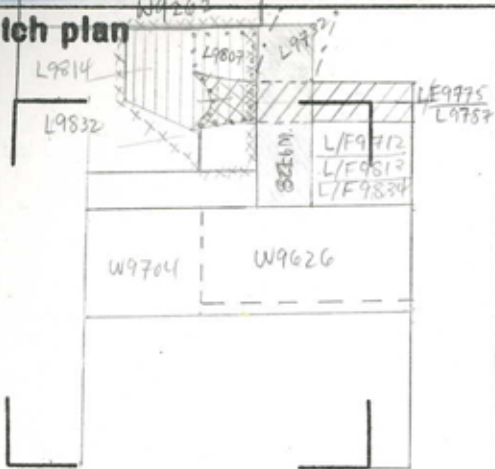
Additional Observations/Value: W9728 is important in that it links AI32 and AI33; it also forms a corner with two walls: W9262 and W9626.

Sketch plan

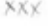

L9770  L9814 
L9807  L9832 
L9776 
L9732 

1:100 N↑



87021

Section

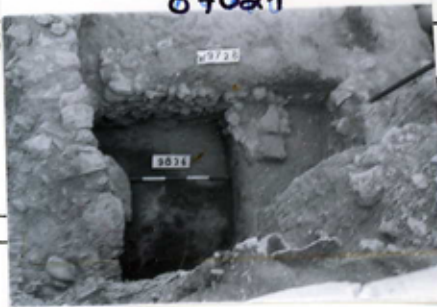
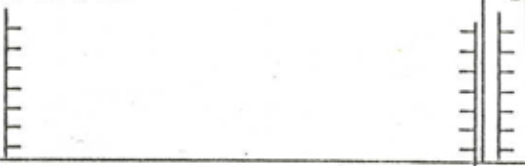

entered

Locus W 9728	Dor 1993	Fld G ₁	Sq A132/33	Loc. type Mudbrick wall and socle
Open 05/07/93	Date	High at 14.56	Low at 14.19	Seals: _____
Close 03/08/93		13.49	13.48	Sealed by: _____
Floor: type _____		_____	Vol _____	Loci _____
Length 2.4	Width 0.7		Drawn? YES	above _____
Value 1	Remove _____			Loci _____
Photo #(1) _____	Photo #(2) _____			below _____
Written by: R.S.S.	Checked by: J.R.Z.			

Unit _____	Phase _____	Stage _____	Stratum _____	PoM _____
Summary _____				

Opened: Beginning of season.

Limits (N) See previous season cards.
(S) See previous season cards.
(E) 19981
(W) L9857, L9878, 19879, W9887 and L9930

Closed: End of season - Floating but not removed.

Matrix: Approximately 7-8 total courses were identified. The wall floats on what appears to be mudbrick debris.

Relations: For all previous relations see previous season cards.
 To the E. the top lip of L9921 touches the base stone of W9728. Mounds F9834 probably continued below W9728.
 To the W. F/L9857 reaches the lower storey of W9728.
 W9887 appears to abut W9728, while the relationship between the wall and F/L9879 and F/L9978 is unclear. W9728 appeared to cut F9878 though this now seems unlikely. F9878 probably reached the wall. F9879 and F9930 are the David floor. F9930 appears to continue below W9728 and probably continues as F9834 to the E. of the wall if this is the case, W9728 is built upon F9834/F9879/F9930, and L9879 and L9930 would reach the base of W9728.

Additional Observations/Value: High value - continuation card.

Sketch plan

W9728

1:100



Section A-A'

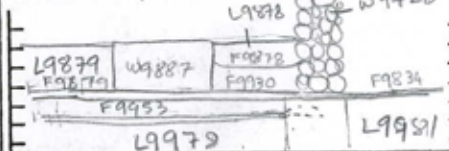

Section

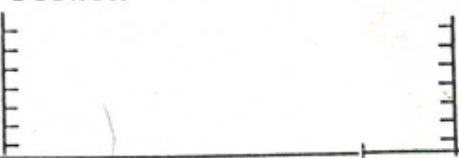

Locus W 19728	Dor 19 ₄	Fld 16	Sq A1B3.2	Loc. type Wall (card 3)
Open	Date 0.5/07/94	High at 14.516 C	Low at 14.110 S	Seals: 118037
Close	1.9/07/94	13.611 N	13.40 S	Sealed by:
Floor: type				Loci
Length 2.4	Width 0.7	Vol		above
Value 1	Remove 1.9/07/94	Drawn? yes		Loci 118037
Photo #(1) 117034	Photo #(2) 117035			below
Written by: J.R.Z	Checked by: J.R.Z			

Unit _____ Phase _____ Stage _____ Stratum _____ PoM _____

Summary _____

Opened: To remove wall 19728

Limits (N) see previous cards

(S) see previous cards

(E) see previous cards

(W) see previous cards

Closed: Removed wall, opened 118037 as sealed deposit down to floor below.

Matrix: see previous cards

Relations: For all relations above N, S, E and W see previous cards

19728 seals and covers 118037 below and 118042 below 118037.

The stone courses of 19728 seemed to slightly dovetail into ^{mudbricks} 19704; if not, the stone portion

19728 abuts mudbricks of 19704.

Additional Photos: 117036-038, 117277-278, 117281-283

Additional Observations/Value: Above 2 floors over destruction deposit,



117038

W9728



117037



117281



117280



117282



117278

Locus

W 11728

Sketch plan A132-33

N ↑

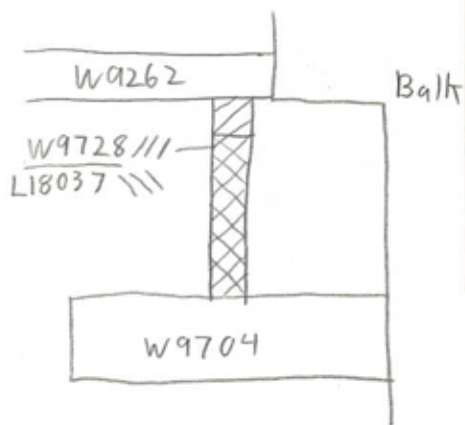

117034



117035

Section

Section