

Do under AA/133 of Chevy

(Cantarad)

Locus L 9753	Dor 1992	Fld 16	Sq AI34	Loc. type PIT / FILL
Open 14/07/92	High at 15.15	Low at 15.11	Seals: _____	
Close 16/07/92	High at 15.15	Low at 14.90	Sealed by: _____	
Floor: type 1	Width 0.5	Vol _____	Locl 9701 9311	
Length 2.2	Remove 16/07/92	Drawn? NO	above _____	
Value 14			below _____	
Photo # (1) _____	Photo # (2) _____		Locl 9797	
Written by: SFB	Checked by: JRB		below _____	

Unil _____	Phase _____	Stage _____	Stratum _____	PoM _____
-------------------	--------------------	--------------------	----------------------	------------------

Summary _____

Opened: OPENED L9753 AT BEGINNING OF 1992 SEASON TO CONTINUE DOWN IN AREA SOUTH OF W9282

Limits (N) L9769

(S) UNEXCAVATED MATERIAL IN BAULK & W9702

(E) L9769

(W) W9684

Closed: PIT MATERIAL OF L9753 SEEMED TO BOTTOM OUT SLOPING DOWN FROM N. TO S. ON "MUDBRICK" OF L9769. FURTHER EXCAVATION SHOWED IT CONTINUED IN L9797.

Matrix: L9753 IS SOFT GRAY/BROWN "PIT" MATERIAL WITH LOTS OF SHERDS. CONTRASTS WITH HARD, BROWN "MUDBRICK COLLAPSE" L9769 SURROUNDING IT TO NW, N, & N.E

Relations: RELATION OF L9753 TO LOCI ABOVE IS HAZY, AS THEY WERE EXCAVATED IN 1991 (L9701) AND 1988 (L9311). I BELIEVE IT CONTINUES PIT/FILL L9701 WHICH CLOSED IMMEDIATELY ABOVE ITS WESTERN PORTION. THERE IS AN ELEVATION CONFLICT WITH L9311 UNLESS L9311 WAS NOT ACTUALLY EXCAVATED TO ITS BOTTOM OF 14.90 WEST OF W9266. L9753 CUTS

SLOPING SOUTH PORTION OF L9769 WHICH IS A CONTINUATION OF L9700 EXCAVATED IN 1991. L9753 REACHES W9684 ON THE WEST & CUTS L9769 TO THE EAST. L9753 CONTINUES INTO BAULK TO THE SOUTH. ITS MATRIX CONTINUES BELOW IN ITS WESTERN PORTION INTO L9797.

NOTE: RELATION OF L9753 TO L9797 IS NOT CERTAIN. I THOUGHT I HAD CLEARED L9753 TO ITS BOTTOM, BUT AFTER CLEARING

Relations: RELATION OF L9753 TO L0C1 ABOVE IS HAZY, AS THEY WERE EXCAVATED IN 1991 (L9701) AND 1988 (L9311). I BELIEVE IT CONTINUES PIT/FILL L9701 WHICH CLOSED IMMEDIATELY ABOVE ITS WESTERN PORTION. THERE IS AN ELEVATION CONFLICT WITH L9311 UNLESS L9311 WAS NOT ACTUALLY EXCAVATED TO ITS BOTTOM OF 14.90 WEST OF W9266 (L9753) CUTS SLOPING SOUTH PORTION OF L9769 WHICH IS A CONTINUATION OF L9700 EXCAVATED IN 1991. [L9753] REACHES W9184 ON THE WEST & CUTS (?) L9769 TO THE EAST. [L9753] CONTINUES INTO BAULK TO THE SOUTH. ITS MATRIX CONTINUES BELOW IN ITS WESTERN PORTION INTO L9797.

NOTE: RELATION OF L9753 TO L9797 IS NOT CERTAIN. I THOUGHT I HAD CLEARED L9753 TO ITS BOTTOM, BUT AFTER CLEARING L9769 TO CLOSING LEVEL OF L9753, MORE PIT MATERIAL WAS VISIBLE ALONG SOUTH BAULK TO WEST. THIS BECAME L9797.

Note: Area S of L9753 was removed hurriedly as a bulk, so it was not possible to trace its limits in that direction. It may have cut L9828 and perhaps F9828.

Additional Observations/Value: L9753 CONTINUES SLOPING SIDE OF LAST YEARS L9701. L9753 YIELDED CYPRIOT PROTO BI-CHROME SHEPHERD

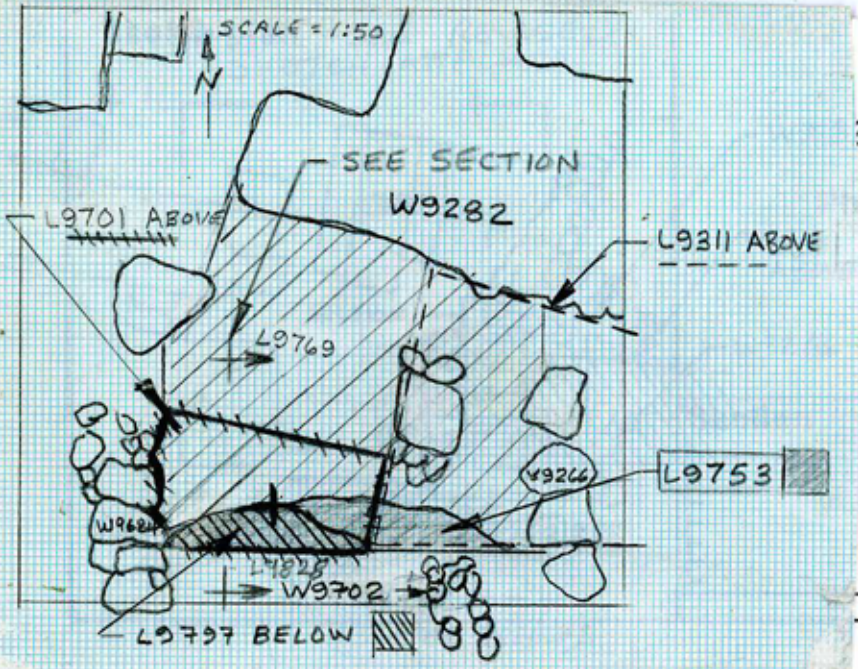

2

olo

Photo

Section

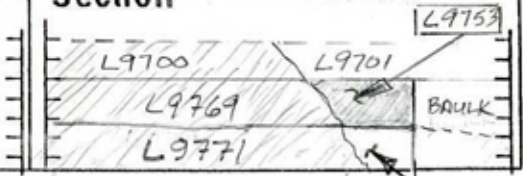

LOOKING EAST

L9797