

(entered)

Locus W 9761	Dor 1992	Flid G	Sq AI34	Loc. type WALL / PAVEMENT (?)
Open Date 1.5.97.92	High at 15.97 W	Low at 15.96 E	Seals: 9767	Sealed by:
Close Date 1.5.07.92	15.77 W	15.72 W	Locl 9205	above
Floor: type	Width 0.5	Vol	Locl 9767	below
Length 0.8	Remove 16/07/92	Drawn? YES		
Photo #(1) 86380	Photo #(2) 86384			
Written by: SFB	Checked by: JRZ			

Unit	Phase	Stage	Stratum	PoM
Summary				

Opened: TWO ASHLARS FROM WHICH THE SURROUNDING MATERIAL HAD BEEN EXCAVATED IN PREVIOUS SEASONS WERE LABELED W9761

Limits (N) L9205

(S) L9205

(E) L9205

(W) L9205

Closed: W9761 WAS OPENED TO PROVIDE REFERENCE NUMBER FOR PLANS & LOCUS CARDS. IT WAS ALREADY EXPOSED AT

Matrix: BEGINNING OF 1981 SEASON

MATRIX: (2) SANDSTONE ASHLARS: (1) 26x51x20/25 (TO WEST) & (1) 56x44x23 (TO EAST). TOP SURFACE PLASTERED (NOT EVIDENT IN 1992)

Relations: W9761 WAS COME DOWN UPON BY L9205 IN 1987 AND MATERIAL OF ALL 4 SIDES WAS EXCAVATED TO A LEVEL OF 15.84/15.81 AS PART OF THAT LOCUS. THE OPENING LEVELS OF ALL ADJACENT LOCI OPENED IN 1991 & 1992 WERE BELOW THE BOTTOM OF W9761. THIS MUST BE ATTRIBUTED TO INTERSEASON EROSION. W9761 SEALS PIT L9767 BELOW.

W9761 MAY BE RELATED TO ASHLAR ADJACENT TO W9085 IN NE CORNER OF AI34 (ABOVE W9774). (CARD FOR L9205 SUGGESTS ROBBING ACTION ALONG NORTH FACE OF W9085). W9761 MAY ALSO HAVE BEEN PART OF A ROBBED OUT N-S WALL ASSOC WITH W9085. ALTHOUGH IDENTIFIED AS A "WALL". THESE ASHLARS MAY HAVE BEEN PART OF A PAVING INSTALLATION. CARD FOR L9205 FROM 1987 SAYS THESE BLOCKS WERE PLASTERED ON UPPER SURFACE. NO PLASTER REMAINED WHEN REMOVED THIS SEASON. ELEVATION OF W9761 IS APPROX. EQUAL TO THAT OF PAVEMENT L9000 IN S. OF AREA G.

ADDITIONAL PHOTOS: 86379, 86381, 86382, 86383

Additional Observations/Value: W9761 IS OF VALUE AS A SEALING FEATURE FOR PERSIAN PIT L9767 AND LOCI BELOW

SCALE = 1:100



L9205 ABOVE & SURROUNDINGS

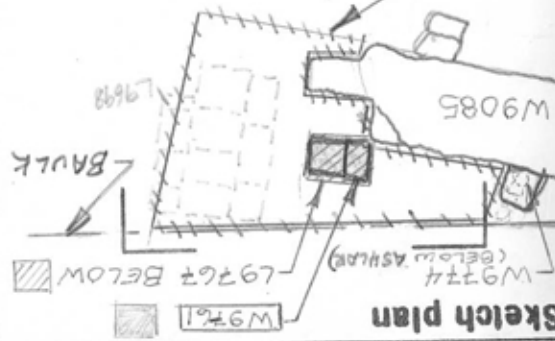

Sketch plan

Section

86380



Section

86384

