

(continued)

Locus LJ 9780	Dor 1992	Fld G	Sq AI34	Loc. type FILL/MUDBRICK COLLAPSE
Open 22/07/92	High at 14.80 S	Low at 14.74 N	Seals: _____	
Close 23/07/92	High at 14.65 S	Low at 14.62 N.W	Sealed by: _____	
Floor: type _____	Length 1.7	Width 1.9	Vol _____	Locl 9754
Value 14	Remove 23/07/92	Drawn? NO		above _____
Photo #(1) _____	Photo #(2) _____			Locl 9789
Written by: SFB	Checked by: JRD			below _____

Unit	Phase	Stage	Stratum	PoM
------	-------	-------	---------	-----

Summary

Opened: WHEN L9754 CAME DOWN UPON A FLOOR IN ITS NORTH PART, IT WAS DIVIDED. IN SOUTH, IT BECAME [L9780]. A SMALL SEGMENT OF PIT, L9778 APPEARED

Limits (N) (NOT YET DUG) AT THIS LEVEL.

- (S) L9801 & L9680 (DUG IN 1991)
- (E) BAULK CONTINUING NORTH FROM W9684
- (W) PITS L9778 & L9680, FOUNDATION STONES OF W9650

Closed: L9780 WAS CLOSED WHEN IT REACHED BOTTOM LEVEL OF ADJOINING PIT L9778

Matrix: CONTINUES MIXED, MEDIUM HARD BROWN FILL OF L9754 ABOVE. DISTINCT FROM GRAY, SHERD FILLED PIT L9778. GROUP OF STONE IMPLEMENTS FOUND IN SOFTER "FLOOR DEPOSIT" MATERIAL S. OF W9085 IS PROBABLY ASSOCIATED WITH FLOOR 9789 BELOW. (*)

Relations: L9780 CONTINUES MATRIX OF SOUTHERN PART OF L9754 ABOVE. TO THE NORTH IT CUTS THE SOUTHERN EDGE OF PARTIAL FLOOR L9754. ITS MATRIX SEEMS TO CONTINUE UNDER W9085 IN THE N.W. TO THE WEST, IT IS CUT BY PERSIAN PIT L9778/L9680* TO THE SOUTH IT REACHES DEGRADED MUDBRICK WALL(?) L9801. TO THE EAST IT CONTINUES INTO BAULK CONTINUING NORTH FROM W9684 & REACHES W9684.

(*) AT WEST, IN NORTH PART L9780 IS CUT BY FOUNDATION OF W9650 L9780 SEEMS TO BE PART OF A LATE IRON AGE DISTURBANCE WHICH CUT A SERIES OF IRON AGE FLOORS AT THEIR SOUTHERN END AND INTO WHICH FILL AFTERWARDS MAY HAVE BEEN DEPOSITED AGAINST MUDBRICK WALL(?) L9777/L9801. AS WE GO DOWN IN THIS AREA, FLOORS ARE EXTANT FURTHER AND FURTHER SOUTH

NOTE GROUP OF STONE IMPLEMENTS FOUND S. OF W9085: 97823, 97842, 1

(*) L9780 IS ALSO DISTINCT FROM DARK BROWN, HARD, VIRTUALLY SHERD FREE DEGRADED MUDBRICK L9801 TO SOUTH.

Additional Observations/Value: FILL IN THIS AREA CAN PROVIDE DATA FOR DETERMINING RELATIVE CHRONOLOGY OF FLOORS L9754 ETC AND MUDBRICK WALL(?) L9777/19801

Photo

Photo

Section

Section

Sketch plan N SCALE = 1:100

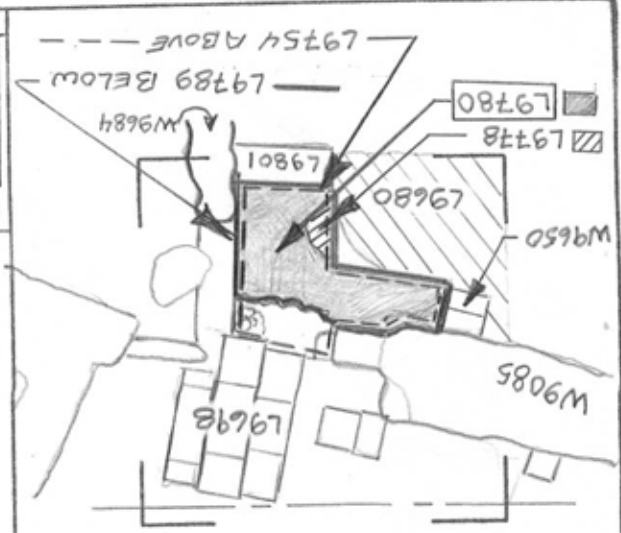

L 9780

St Lc

Df St Ob Ma R C P1 P2 P3

sa ma bn d

sa sh cr 0 d ---

sa sh cr 1 u ir1 ir2a

sa ma bn u

sa tw st u

sa tw st u
and 1 unknown.

sa sh cr 2 u ir1
9085, Ir2a? 1 bic.

sa ma bn u