

(entered)

Locus L 9787	Dor 1992	Fld G ₁	Sq AI32	Loc. type Floor makeup and fill below
Open 23/07/92	High 14.53	at E ₁	Low 14.51	at W ₁
Close 29/07/92	High 13.95	at W ₁	Low 13.94	at E ₁
Floor: type —	Length 0.8	Width 0.5	Vol	Locl 9775
Value W ₁	Remove —	Drawn? N ₀₁	above —	below —
Photo #(1) NONE	Photo #(2) —	Written by: RAIT	Checked by: RAIT	Locl none yet
				below —

Unit	Phase	Stage	Stratum	PoM
------	-------	-------	---------	-----

Summary

Opened: Came down on fragmentary floor [F9775]; closed [L/F9775] and opened [L9787] as floormakeup and fill below

Limits (N) Bounded by [L9095] and below, and by [L9732] and below

(S) Bounded by [L9678] and material below ([L9685], [L9690], and [L9712])

(E) Bounded by material in East bank of AI32 and AI33

(W) Bounded by [W9728]

Closed: Brought [L9787] down to level of stone socle of [W9728]

Matrix: [F9775] fragmentary, preserved mainly at South East end of locus; floor makeup of [F9775] very thin patchy kurkar. Fill is grey-brown mudbrick debris, with flecks of kurkar, and towards bottom of locus, increasing amounts of yellow-gray ash material mixed with mudbrick debris; moderate amount pottery; large root growing at South center

Relations: [L9775] and [F9775] cover, but do not seal, [L9787] due to the fragmentary nature of [L9787]. [L9787] covers, but does not seal below

To the North, [L9787] continues into the material below [L9095] and into [L9732] and the material below [L9732].

To the South, [L9787] seems to continue into [L9678] although no floor was observed in [L9787] at the level of [F9678]. [L9787] also seems to continue into [L9685]. [L9787] also continues in the fill of [L9690], but no floor was observed in [L9787] at the level of [F9690]. [L9787] also continues into the fill of [L9712], but no floor was observed in [L9787] at the level of [F9712].

To the East, [L9787] continues into the East bank of AI32 and AI33.

To the West, [L9787] appears to reach ^{the socle of} [W9728].

Note: Final basket for [L9787] may contain material from both superstructure and foundation of [W9728]

Additional Observations/Value: Since unsealed, only of medium value.

Photo

Photo

Section

Section

Sketch plan

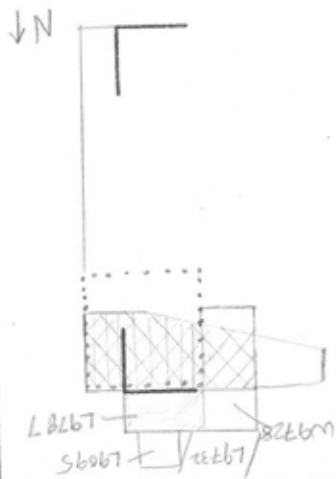

- AT32
- 1/100
- ▨ F/L9678
- ▨ 19685
- ▨ L9690
- ... F/L9712

L 9787

St Lc P2 P3
Df St Ob Ma R C P1

sa sh cr 2 u ir1

sa ma bn u

sa sh cr 0 u --

sa sh cr 0 u ir

sa sh cr 2 u ir1

sa ma bn u

sa tw st u