

(entered)

Locus LJ 9788	Dor 19 912	Fld 91	Sq A 623	Loc. type STRATIFIED ACCUMULATION
Open 23/07/92	High at L5.83 W1	Low at L5.83 E1	Seals: _____	
Close 12/08/92	High at L5.28 W1	Low at L5.26 E1	Sealed by: _____	
Floor: type _____	Length L. 9.1m	Width L. 4m	Vol _____	Locl 9757
Value U1	Remove _____	Drawn? NO	above _____	
Photo # (1) _____	Photo # (2) _____	Locl NONE AT THIS TIME.	below _____	
Written by: SPB	Checked by: JRZ			

Unit	Phase	Stage	Stratum	PoM
------	-------	-------	---------	-----

Summary

Opened: TO INVESTIGATE A CHANGE IN POTTERY TYPE FROM MIXED IR AND P TO ALL IR, IN AN AREA OF A HIGH CONCENTRATION OF COBBLES.

Limits (N) BOUNDED BY THE NORTH BANK.

(S) BOUNDED BY W9792 AND L9796

(E) BOUNDED BY EAST BANK

(W) BOUNDED BY L9819 AND L9796

Closed: NOT CLOSED - END OF SEASON

Matrix: MODERATELY COMPACT MEDIUM GREY-BROWN SOIL WITH A PATCH OF SOFTER SOIL ON THE EAST SIDE WHICH BEGINS 6cm FROM THE EAST BANK AND EXTENDS IN 20cm INTO THE LOCUS. POTTERY SHEERDS ARE ALL IRON AGE. SOME FIST-SIZE COBBLES, CHARCOAL FLECKS, AND BONE THROUGHOUT. A HIGH PERCENTAGE OF IRON PIECES AND IRON SLAG WERE RECOVERED. INITIALLY, A HIGH PERCENTAGE OF FIST- AND DOUBLE FIST-SIZED IRON PIECES AND IRON SLAG WERE RECOVERED.

Relations: L9788 IS COVERED BUT NOT SEALED BY L9757. IT IS CUT BY THE PERSIAN PIT/FILL L9796, WHICH CAN BE SEEN IN THE DIFFERENCES OF MATRIX. WHILE L9796 HAS A MIXTURE OF POTTERY TYPES, RANGING IN TIME FROM IR TO P, L9788 HAS ONLY IR POTTERY. L9788 CONTAINS FAR LESS BONE THAN L9796, BUT MUCH MORE IRON AND IRON SLAG. THE COLOR AND TEXTURE OF THE SOIL ITSELF IS NOT DIFFERENT BETWEEN THE TWO LOCI. L9788 IS CUT BY L9819, THE SUMP/STORAGE BIN. THE MATRIX OF L9788 CONTINUES UNDER THE BANK WHERE IT IS CUT BY W9560 IN A624. THE SAME MATRIX SEEMS TO CONTINUE INTO THE EAST BANK. THE MATRIX INSIDE THE WALLS OF THE SUMP/STORAGE BIN, L9819, IS MUCH FINER AND SANDIER THAN L9788, AND CONTAINS POTTERY TYPES SIMILAR TO THOSE FOUND IN L9796. WHILE THIS FILL MAY BE OF MORE RECENT DEPOSITION THAN L9788, THE STRUCTURE OF L9819 ITSELF MAY BE OF IRON AGE CONSTRUCTION. W9792 IS ONLY A FEW COURSES HIGH AND IT APPEARS TO FLOAT IN L9788, INDICATING THAT IT CUTS L9788. THE PEDESTAL ON WHICH IT RESTS IS ASHIER THAN L9788 AND CONTAINS MORE SHELL, BONE, AND 1/4 FIST-SIZE STONES.

475? 11/13 19 4-6

Additional Observations/Value: L9788 IS UNSEALED AND SO HAS LITTLE STRATIGRAPHIC VALUE

Photo

Section

Photo

Section

Sketch plan

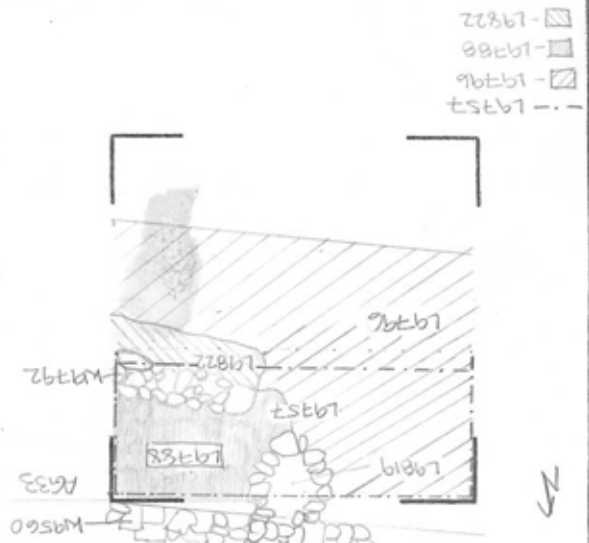

L 9788

St Lc

Df St Ob Ma R C P1 P2 P3

sa sh cr 3 d ir2c
profile for jar. (R?).

sa sh cr 3 d ir2c

sa sh cr 2 d ir2

ia ma bn d

a ot st d

sh cr 0 ?d --

ot ir u

sh cr 2 u ir2c

sh 18 5m