

(continued)

Locus L9808	Dor 1992	Fld G	Sq A133	Loc. type Mudbrick debris to wall		
Open 2/9/92	Date	High 13.88	at N	Low 13.87	at S	Seals: _____
Close 10/28/92		High 13.69	at N	Low 13.63	at S	Sealed by: _____
Floor: type		Width 2.5		Vol		Locl 9755
Length 2.5		Remove 10/98/92		Drawn? No		above _____
Value 4						below _____
Photo # (1)		Photo # (2)		Locl 9835	9841	9842
Written by: R.S.S.		Checked by: J.R.Z.				

Unit	Phase	Stage	Stratum	PoM
------	-------	-------	---------	-----

Summary

Opened: L9755 split into L9808 and L9816 when large area of rubble appeared in w. end at top of stone socle for W9262.

Limits (N) Bulk with A134

(S) Stone socle for W9262

(E) W9684 and L9816

(W) W9275 and TZ with pit L9251.

Closed: Reached top of W9841 - split into L9835, W9841 and L9842.

Matrix: Medium brown to dark brown, dense, compact mudbrick debris similar to L9755 above. Areas of bivalve shell concentration. Very little pottery recovered. In the N. half, increasing number of fist-sized to quadruple fist-sized cobbles and small boulders in NW.

Relations: L9755 completely covers [L9808], and [L9808] is a continuation below of L9755. [L9808] covers but does not seal L9835, L9842 and the w. half of W9841. In the N. half, increasing number of fist-sized to quadruple fist-sized cobbles and small boulders in NW.

[L9808] reaches to the S. ^{only} the stone socle for W9262. In the SE corner [L9808] reaches the w. face of W9684. Along the rest of its E. edge, [L9808] reaches the rubble locus L9816. [L9808] appears to continue N. into the bulk with A134. To the w., [L9808] continues into the TZ with pit L9251. Presumably, [L9808] would have been cut by L9251, but this relationship has been obscured by erosion. Also to the w., [L9808] reaches the E. face of W9275.

Note that any floor W. of and reaching the upper phase of W9684 must be higher than the rubble of L9816, at least 14.30.

Additional Observations/Value: Low stratigraphic value - 1r mudbrick debris to W9841 and rubble

Photo

Photo

Section

Section

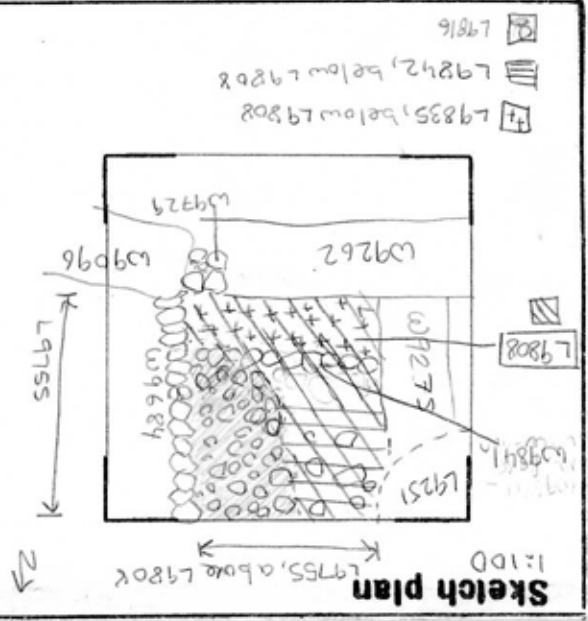

L 9808

Lc

St Ob Ma R C P1 P2 P3

sh cr 2 u ir

ma bn u

tw st 2 u ir1

sh cr 0 u --

sh cr 2 u ir2a

tw st u

jw sl u