

(entered)

|                      |                                    |                 |                |                            |
|----------------------|------------------------------------|-----------------|----------------|----------------------------|
| Locus<br>L 9812      | Dor 1992                           | Fld G           | Sq AI 32       | Loc. type<br>Floor deposit |
| Open                 | Date 29/07/92                      | High at 12.62 S | Low at 12.50 N | Seals: none yet            |
| Close                | 14/08/92                           | 12.53 W         | 12.48 E        | Sealed by:                 |
| Floor: type Cf       |                                    | 12.53 W         | 12.48 E        | Locl 9795 9762             |
| Length 2.4           | Width 1.0                          | Vol             | Drawn? Y, E, S | above                      |
| Value 4              | Remove                             |                 |                | below                      |
| Photo # (1) ask Isra | Photo # (2) <del>87078</del> 95664 |                 |                |                            |
| Written by: RAT      | Checked by: J.R.Z                  |                 |                |                            |

|      |       |       |         |     |
|------|-------|-------|---------|-----|
| Unli | Phase | Stage | Stratum | PoM |
|------|-------|-------|---------|-----|

Summary

**Opened:** In excavating [F9795], floor disappeared to South and material became soft and loose, dark-black charcoal debris; closed L9795 and opened [L9812] as charcoal debris material.

**Limits (N)** Bound by [L/F9795] and by [L9805]

**(S)** Bound by [W9800] and South bank of AI32

**(E)** Bound by [L9762] and East bank of AI32

**(W)** Bound by [W9804]

**Closed:** Came down on [F9812] - End of Season

**Matrix:** Fill of [L9812] is dark-black, soft, loose, and moist material, with a large pocket of white sand in the South west, lots of charcoal, mostly powder, but one large chunk of burnt wood; small amount of pottery; down to a thin white powdery floor with flecks of charcoal; organic material for analysis found on floor, as well as a few murex shells and bones.

**Relations:** [L9795] covers, but does not seal, [L9812]. [F9795] does not cover [L9812]. [L9762] covers, but does not seal, the Eastern end of [L9812]. [F9812] appears to underlie the Southern part of [L9762]. [L/F9812] cover and seal the unnamed material below. [F9812] appears to be an earlier surface (pre-destruction), and [F9795] a resurfacing (contemporary with destruction) of some floor. To the North, the fill of [L9812] appears to reach [L9805], [F9812] could not, however, be traced as reaching [L9805], although it probably did so. [F9812] probably underlies [F9795] though this is uncertain until the material below [F9795] is excavated. As stated above, the fill of [L9795] covers [L9812].

To the South, [L/F9812] reach [W9800], as well as continue into the South bank of AI32.

To the East, [L9812] is cut by pit [L9762]; the center of pit [L9762] also cuts [F9812]. [F9812], however, underlies the remainder of pit [L9762] (see sketch).

To the West, [L/F9812] reach [W9804].

**Additional Observations/Value:** Because of its position beneath the destruction debris loci and being a certain floor, of very high value.

98106 AI32 12.58 12.48 fd sh cr 0  
 Pottery, north half. Check with L9795, L9829, L9  
 98107 AI32 12.58 12.48 fd ma bn  
 Bone, north half.

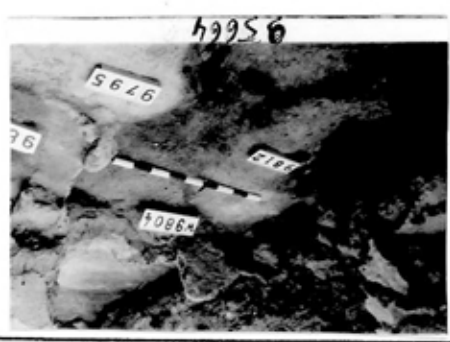
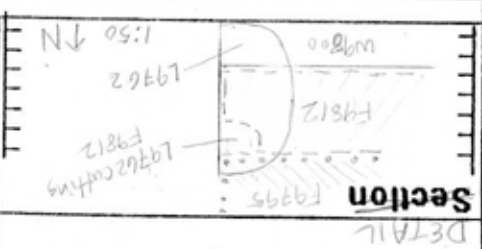
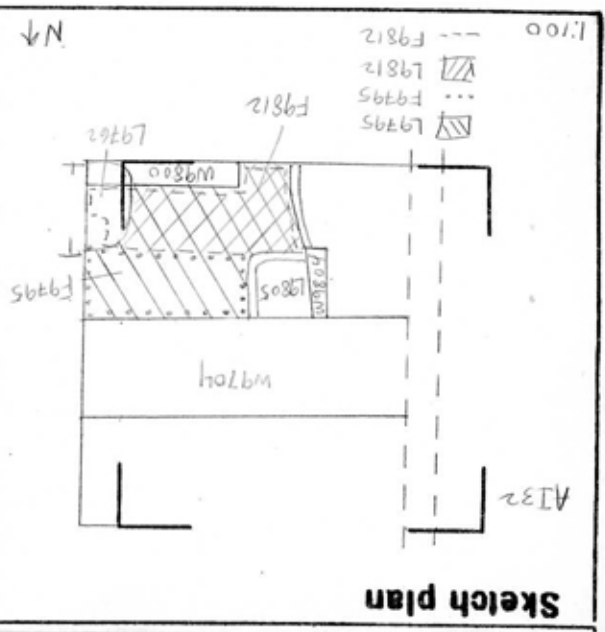

Photo

Section

Sketch plan