

(entered)

<b>Locus</b> 49817	<b>Dor</b> 1992	<b>Fld</b> G	<b>Sq</b> A1/AH33	<b>Loc. type</b> Fill to floor
<b>Open</b> 07/30/92	<b>High</b> 14.15	<b>at</b> E	<b>Low</b> 14.11	<b>at</b> W
<b>Close</b> 08/05/92	<b>High</b> 14.04	<b>at</b> N/E	<b>Low</b> 14.04	<b>at</b> S/W
<b>Floor:</b> type P	<b>High</b> 14.02	<b>at</b> S	<b>Low</b> 14.00	<b>at</b> N
<b>Length</b> 2.3	<b>Width</b> 2.0	<b>Vol</b> [diagram]	<b>Drawn?</b> YES	
<b>Value</b> 11	<b>Remove</b> 07/25/92			
<b>Photo #(1)</b> 86853	<b>Photo #(2)</b> 86853			
<b>Written by:</b> RSE	<b>Checked by:</b> JRZ			

<b>Unl</b>	<b>Phase</b>	<b>Stage</b>	<b>Stratum</b>	<b>PoM</b>
------------	--------------	--------------	----------------	------------

**Summary**

**Opened:** Below L9759 to explore area to the N. and W. of the mudbrick "installation" or wall, L9826.

**Limits (N)** Back with A1/AH34

**(S)** L9827, [unclear] and fill below L9096.

**(E)** W9266

**(W)** W9684

**Closed:** when reached floor 9817 in W. half of locus.

**Matrix:** E. half of locus was compact, fallen mudbricks, including visible whole Hurkar mudbricks. Similar to L9759 above. W. half was loose med brown soil, very rich in pottery. 5cm thick ash lens covered the floor, including large flecks of charcoal. Not similar to L9759 above. Floor was soft, ash and lime rich heather earth floor.

**Relations:** The E. half of [L9817] is a continuation below of L9759. L9759 covers but does not seal [L9817]. The W. half of [L9817], though similar to some of the matrix found at the base of L9759 in its SW corner (see L9759 card), is not a continuation below L9759. [L9817] is much richer in pottery than the area above in L9759.

Note that 9759 ended on a small floor. 9826 may have been raised as part of the floor of 9759. [L9817] is below this 9759 floor level.

To the N, [L9817] appears to continue into the back with A1/AH34. To the E, [L9817] reaches the W. face of W9266. To the W, [L9817] either reaches or is cut by the E. face of W9684. The floor 9817 does not reach W9684, suggesting that it is cut by the FT of W9684. If this is the top level of the FT, then [L9817] reaches W9684. However if the FT begins higher than the base level of [L9817], then W9684 cuts [L9817]. [L9817] reaches the N. and W. faces of L9827. Floor 9817 does not reach L9827, but [unclear] will have been a living area related to the pedestal of mudbricks L9827. [L9817] covers but does not seal unexcavated material in the E. end of locus, and covers and may seal below floor 9817. An unexcavated material in the W. end of locus. The E. end of the locus (the fallen mudbricks) may be fall from L9827, pushed over to create a level floor area in L9827. The fall may also be related to an earlier phase wall, or to a wall related either to W9266 or W9684.

**Additional Observations/Value:** Tr1/2a fill to floor. Valuable.

Additional photos- 86679, 86680

Sketch plan 1:100

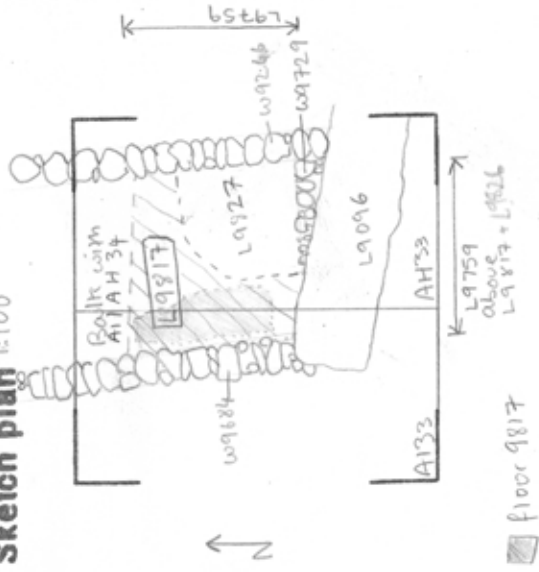

Section

