

(centered)

<b>Locus</b> L 9836	<b>Dor</b> 19 92	<b>Fld</b> G1	<b>Sq</b> A133	<b>Loc. type</b> Floor! makeup, fill to floor.
<b>Open</b> 0.2, 0.8, 92	<b>High</b> 13.64	<b>at</b> S	<b>Low</b> 13.63	<b>at</b> N
<b>Close</b> 11/0.8/0	<b>High</b> 13.36	<b>at</b> S	<b>Low</b> 13.34	<b>at</b> N
<b>Floor: type</b> SF	<b>High</b> 13.36	<b>at</b> S	<b>Low</b> 13.34	<b>at</b> N
<b>Length</b> L-2	<b>Width</b> 0.6	<b>Vol</b>	<b>Locl</b> 9823	
<b>Value</b> P1	<b>Remove</b> / / /	<b>Drawn?</b> NO	<b>above</b>	
<b>Photo # (1)</b> Ask Isra	<b>Photo # (2)</b>	<b>Locl</b>		
<b>Written by:</b> PSS	<b>Checked by:</b> JLR	<b>below</b>		

<b>Unit</b>	<b>Phase</b>	<b>Stage</b>	<b>Stratum</b> 8/77	<b>PoM</b> 8+7 (u)
<b>Summary</b>				

**Opened:** New locus opened to excavate area below floor 9823.

**Limits (N):** L9251  
**(S)** Stone socle for W9262  
**(E)** Stone socle for W9275  
**(W)** L9168 and TZ between L9168 and L9251

**Closed:** When came down on floor 9836, and end of season.

**Matrix:** Matrix is denser darker mudbrick than L9823 above. Mudbrick debris put directly on the floor - there was no ash lens, though mudbrick was often a dark ash color and texture. Much less pottery than L9823 above. Floor was between ash and lime with areas of dark, burnt ash, and few areas of plaster. At least

**Relations:** two resurfacings were clear when the floor was defined. Several fallen mudbricks were seen in W. section - possible related to destruction seen in TZ for W9841 to E. F9823 above was a small patch of plaster floor - fragments were seen in W. section of L9836.

**RELATIONS:** L9823 completely covers but does not seal L9836. L9836 does not appear to be a continuation of L9823. L9836 will cover and seal an as yet unexcavated or unnumbered locus.

L9836 reaches to the W., the E. face of the stone socle for W9275. L9836 appears to reach N. face of stone socle for W9262, though it may be cut by it. Relationship uncertain. L9836 appears to continue to the N. into a TZ with pit L9251, and also to W. into a TZ between pits L9251 and L9168, and also into a TZ between L9836 and L9168. Floor 9836 appears to reach the whole length of the socle for W9275, though there is a small gap (3cm) between the wall and the floor. The floor does not rise as it approaches W9262, but remains level. Floor 9836 approaches W9262 but does not reach it. The relationship is obscured by poor preservation. Though W9262 probably cut floor 9836 at this point, because it appears that this is the top of the socle for W9262 (This was seen when we excavated L9835 to the E. of W9275) W9262 also then would cut L9836. Hopefully Gila. will draw the floor.

**Additional Observations/Value:** High value - Early 1r floor which will seal unexcavated locus below.

Photo	Section
Section	Section

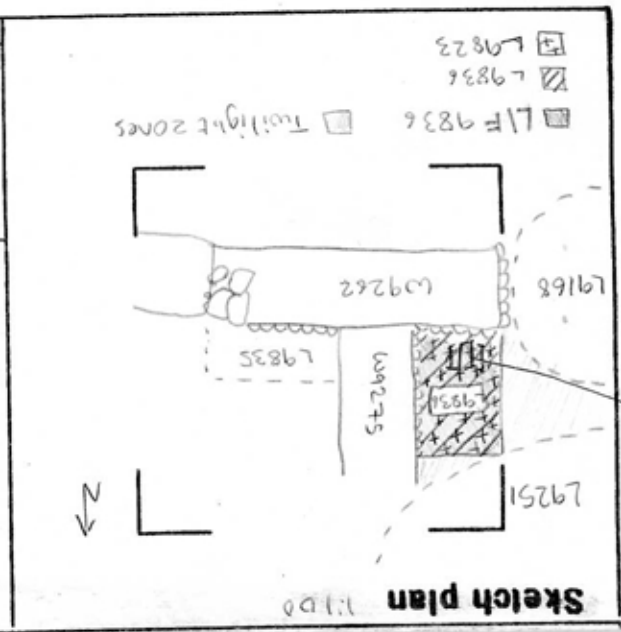
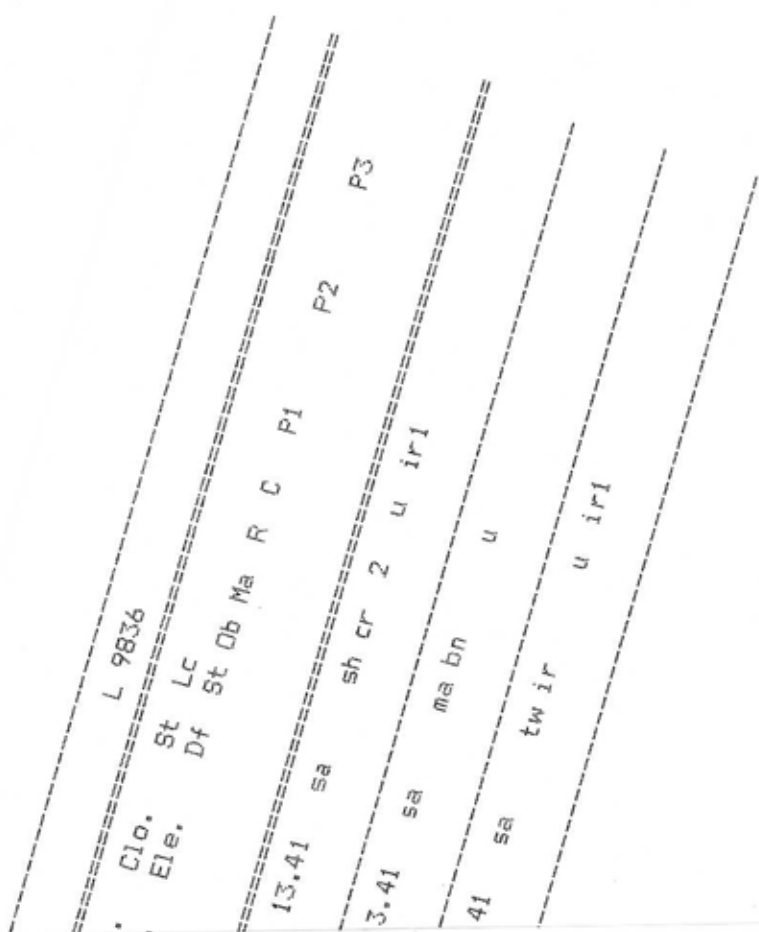

L9823