

Locus L 9861	Dor 19 93	Fld G	Sq AJ34	Loc. type Horizontal Twilight Zone
Open Date 06/07/93	High at L4. L6 E	Low at L3. 9.6 SE	Seals: L9881	_____
Close Date 09/07/93	L3. 8.1 SE	L3. 7.7 NE	Sealed by: L9548	_____
Floor: type I	_____	_____	Locl L9407 L9548	_____
Length 2.4	Width L. 8	Vol 	above _____	_____
Value dl	Remove ___/___/___	Drawn? ___	Locl L9881	_____
Photo #(1) _____	Photo #(2) _____	Locl below _____	_____	_____
Written by: JYS	Checked by: JRR	_____	_____	_____

Unit	Phase	Stage	Stratum	PoM
------	-------	-------	---------	-----

Summary _____

Opened: To provide a twilight zone between [L9548] and the material previously sealed below by floor II+III of [L9548] to account for erosional material from the last 4 years.

Limits (N) Bounded by [W9216] and the unexcavated material below [W9085] to the North.
(S) Bounded by [W9211] to the South.
(E) Bounded by [L9186] to the East.
(W) Bounded by [W9408] to the West.

Closed: Excavated down far enough to account for any erosional intrusion; purpose of horizontal twilight zone completed.

Matrix: Fallen mudbrick material, mostly brown with some orange brick w/ kurkar bits in fragments, disassociated reed matting material, small kurkar bits, pieces of fallen flooring or wall covering, many sherds, bone, charcoal, grey ashy deposits, and few stones 10-20cm (3-4).

Relations: [L9861] is covered by [L9407] and [L9548]. [L9861] is of a similar matrix to [L9407], although [L9407] contained fewer sherds. Floors II and III of [L9548] sealed a portion of [L9861]. [L9186] cuts [L9861] at the eastern limit of [L9861]. [L9861] reaches [W9211]. [L9861] appears to be cut by [W9216] since the unexcavated material below this wall appears to be a continuation of the matrix of [L9861]. [L9861] covers [L9881], which is of the same depositional unit and matrix. [L9861] reaches the plaster face of the eastern side of [W9408]. Although [L9861] reaches [W9211], it is also possible that [W9211] cuts [L9861]. The relationship of any possible floors in the loci below [L9861] to [W9211] will reveal the relationship of [L9861] to [W9211] more clearly. The material of Floors II and III of [L9548] (see card for [L9548]) is contained within the matrix of the horizontal twilight zone of [L9861], although most of this material has probably eroded away since this area was last excavated in 1989.

Additional Observations/Value: Iron Age fill below Iron I/IIa floor. Disturbed by 4 years of erosion. Disturbed, but High Value.

98663 AJ34
-bone- horizontal tz 13.96 13.84 tz ma bn d

98684 AJ34
sling ball 13.79 13.79 tz d

98696 AJ34
worked flint 13.96 13.84 tz tw st d

98697 AJ34
pottery- horizontal tz 13.96 13.84 tz tw st d

crucible (?) link with #98662- 1 mb?, frag

98662 AJ34

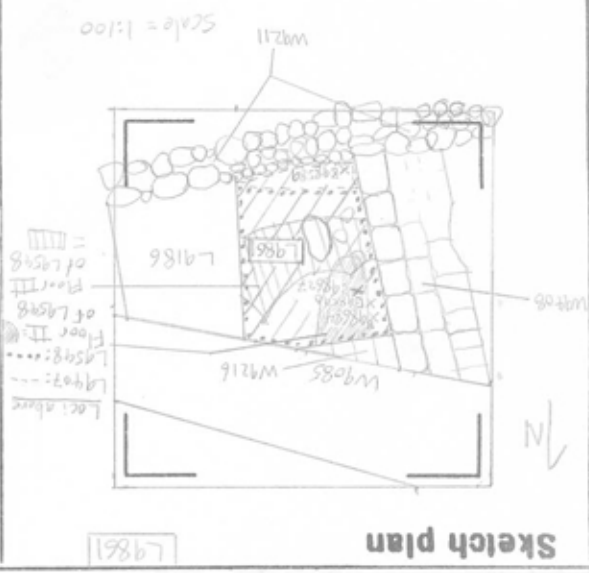

Section
Files in photos unnumbered!



Section