

Locus L 31864	Dor 19 313	Fld 61	Sq A1633	Loc. type STRATIFIED ACCUMULATION
Open Date 017/017/913	High at 1.5 * 2.16 S/E	Low at 1.5 * 1.17 N/W	Seals: N/A 	
Close Date 12/02/913	1.5 * 2.18 S/E	1.5 * 0.15 N/W	Sealed by: N/A 	
Floor: N/A type	Width 	Vol 	Locl above 91854 	
Length     M	Remove 	Drawn? N/A	Locl below 91889 W191815 	
Photo #(1) N/A	Photo #(2)	Written by: GISC	Checked by: IRZ	

Unit	Phase	Stage	Stratum	PoM
------	-------	-------	---------	-----

Summary

Opened: AT BEGINNING OF SEASON, AFTER REMOVAL OF WINTER WASH (CLEANING LOCUS L9854).

Limits (N) L9875 AND L9862  
 (S) UNNUMBERED PEDESTAL OF W9278  
 (E) L9863 AND L9890.  
 (W) WEST BANK.

Closed: A TECHNICAL CLOSURE: W9885 EMERGED WITHIN LOCUS UPON ITS EXCAVATION. L9864 WAS SUBSEQUENTLY CLOSED AND SPLIT INTO L9889 AND W9885.

Matrix: MODERATELY COMPACT, REDDISH BROWN SOIL. FEW COBBLES, SEEDS, OR ANY MATERIAL OTHER THAN SOIL EMERGED FROM THIS LOCUS. L9864 YIELD A MODERATE AMOUNT OF IRON SLAG AND SOME STONE TOOLS. MATRIX IS A CONTINUATION OF L9862, AND MATRIX CONTINUES INTO L9889 BELOW. DIFFERS FROM THE GRAY-WHITE ASH SAND PIT L9875, AND THE SANDY WHITE PERWAN'DIT (L9890) TO THE EAST.

Relations: TO THE NORTH, PIT L9875 CUTS L9864. TO THE EAST, L9864 CAME DOWN UPON W9885 AND WAS FURTHER EXCAVATED TO ABOUT 5CM BELOW THE TOP OF W9885. L9864 COVERS AND REACHES W9885; W9885 DID NOT HAVE A VISIBLE FOUNDATION TRENCH. IN ADDITION, L9864 IS CUT BY PITS L9863 AND L9890, BELOW. TO THE SOUTH, W9278 IS FLOATING AND WE SHOULD ASSUME ITS PEDESTAL IS A PROBABLE FOUNDATION TRENCH. THE UPPER EASTERN MOST L9864 IS CUT BY THE UNNUMBERED PEDESTAL BELOW W9278.

L9864 COVERS, BUT DOES NOT SEAL, L9889. W9889 IS OF THE SAME MATRIX AS L9864 AND IS SIMPLY A LOWER CONTINUATION OF L9864. L9864 IS A HORIZONTAL CONTINUATION OF L9862, AS THEIR MATRICES ARE THE SAME, EXCEPT THAT L9862 HAS A HIGHER CONCENTRATION OF CHERDS, BONE, AND IRON SLAG.

Additional Observations/Value: MEDIUM VALUE - APPEARS TO BE A CLEAN, GENERAL IRON AGE DEPOSIT.

Locus Basket List

L 9864

Bask. No.	Sq. Comments	Req. Ele.	Cl. Ele.	St Df	Lc Db	Ma R	C C	P1
98744	AG33 pottery	15.26	15.07	sa	sh cr	2	u	ir
98745	AG33 bone	15.26	15.07	sa	ma bn		u	
98746	AG33 iron	15.26	15.07	sa	ma ir		u	
98777	AG33 scraper (?)	15.26	15.07	sa	tw st		u	
98835	AG33 pottery	15.12	15.05	sa	sh cr	2	u	ir
98836	AG33 bone	15.12	15.05	sa	ma bn		u	
98863	AG33 Painted potsherd. Attic	15.12	15.05	sa	sh cr	2	u	pr

-- black with red stripes -- 1 pr

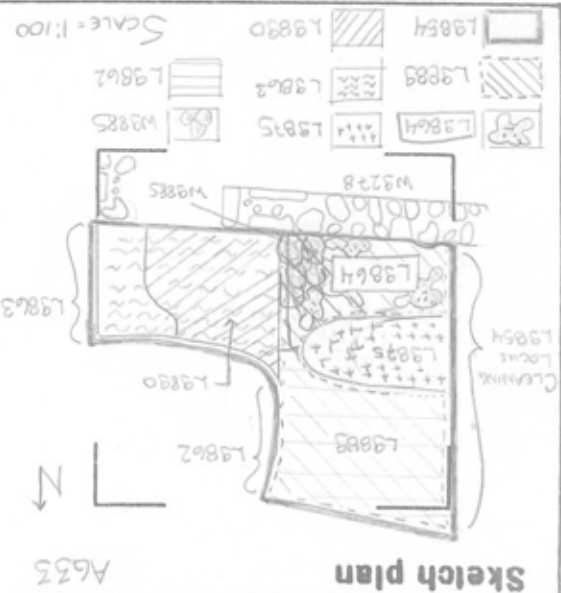

Section

Photo

Section

Photo