

Locus L9866	Dor 1993	Fld G	Sq A134	Loc. type Fill to wall
Open Date 0.6/07/93	High at 14.5.6 S	Low at 14.4.3 N	Seals: _____	_____
Close Date 07/07/93	14.5.0 E	14.2.1 SW	Sealed by: _____	_____
Floor: type Length 2.0	Width 2.0	Vol 	Locl 9789	9801
Value ?id	Remove 1/1/1	Drawn? NP	above _____	_____
Photo #(1) _____	Photo #(2) _____	Locl 9211	9872	_____
Written by: R.S.S	Checked by: J.R.Z	below _____	_____	_____

Unit	Phase	Stage	Stratum	PoM
------	-------	-------	---------	-----

Summary

Opened: To begin to bring the S. half of A134 down to the level of the N. half at A133 so a larger expanse could be excavated.

Limits (N) Unexcavated fill below F9754
 (S) L9694 and L9755
 (E) W9684 and unexcavated bank adjacent to L9838
 (W) L9680

Closed: When locus came down on the E continuation of W9211 Divided into L9732 S. of wall and unnumbered area N. of wall.

Matrix: Compact, hard medium brown mudbrick debris with many fist-sized and larger cobbles. Sparse pottery. Matrix interspersed with fingernail size pieces of charcoal. Fragmentary iron blade(?) found. In N. bank, turtar floor was noted at 14.46. Similar to mudbrick debris loci L9801, L9879, L9694, L9755, L9872 and L9838.

Relations: L9866 is a continuation of L9801 above, and also of the S. extension of L9789 which has a similar matrix to the adjacent L9801.

To the S of W9211 L9866 continues below as L9872. L9866 covers but does not seal W9211 and appears to continue below into the fill to the N. of W9211.

To the N. L9866 appears to continue into the fill below F9754.

To the S. L9866 continues into the mudbrick debris loci L9694 and L9755.

To the W. L9866 is cut by the Persian pit L9680.

To the E. L9866 reaches the W. face of W9684 and appears to continue into the bank N. of this wall with L9838.

The turtar floor in the N. section was approximately at the upper surviving level of W9211 and therefore probably did not relate to it.

Additional Observations/Value: Mudbrick debris covering section of W9211; turtar floor in N. section; low value.

Photo

Section

Photo

Section

Sketch plan 1:100 L9866

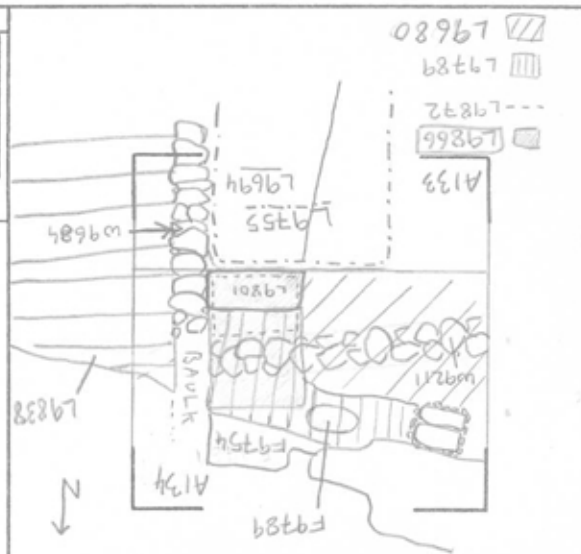

L 9866

St Lc

Df St Ob Ma R C P1 P2 P3

25 sa sh cr 3 ?d ir1
VI, 1 BIC, 1 pr (ATC)

25 sa ma bn ?d

25 sa tw ir ?d

25 sa tw st u

25 sa tw st u
e groove (?)

9 sa sh cr 2 ?d ir1

9 sa ma bn ?d

1 sa tw st ?d