

<b>Locus</b> Q 9886	<b>Dor</b> 1993	<b>Fld</b> G <sub>1</sub>	<b>Sq</b> A583	<b>Loc. type</b> Possible mudbrick partition wall
<b>Open</b> 12/27/93	<b>High</b> at 13.37 E	<b>Low</b> at 13.36 W	<b>Seals:</b> _____	
<b>Close</b> 12/27/93	<b>High</b> at 13.49 E	<b>Low</b> at 13.48 W	<b>Sealed by:</b> _____	
<b>Floor:</b> type L	<b>Width</b> 0.2	<b>Vol</b>	<b>Locl</b> 9873	
<b>Length</b> L.O.	<b>Remove</b> / / /	<b>Drawn?</b> Y/E/S	<b>above</b> _____	
<b>Value</b> P?			<b>below</b> _____	
<b>Photo # (1)</b> 100928	<b>Photo # (2)</b> 100929	<b>Locl</b> _____		
<b>Written by:</b> R.S.D.	<b>Checked by:</b> J.R.Z.	<b>below</b> _____		

<b>Unit</b>	<b>Phase</b> 877	<b>Stage</b>	<b>Stratum</b>	<b>PoM</b>
-------------	------------------	--------------	----------------	------------

**Summary**

**Opened:** L9873 came down on a mudbrick line interpreted as a possible mudbrick partition wall W9886.

**Limits (N)** L9873  
**(S)** Unexcavated area below L9873  
**(E)** L9836  
**(W)** W9140

**Closed:** Not closed; wall still standing

**Matrix:** A line of dark grey mudbrick material. No individual bricks were seen.

**Relations:** W9886 abuts the stone wall W9140.

L9873 covers and also reaches the N. face of W9886.  
 The unexcavated fill below the S. extension of L9873 presumably reaches the S. face of W9886.  
 It is uncertain whether W9886 continued E. into L9836. No similar feature was seen in this locus.  
 W9836 also presumably floats on the hypothetical floor L9873.

Because the line of grey mudbrick is far from straight, and the whole area is filled with fallen mudbrick debris (also note that this fall was clearly visible in the W. Section of L9836), it is doubtful that this is a partition wall.

However, it is also on an approximate line with W9841 to the E. and the complete pot found in L9873 would have sat in the corner of W9886 and W9140.

L9873 is both above and N of W9886 because W9886 was not recognized until the N part of L9873 had been excavated.

**Additional Observations/Value:** Mudbrick partition wall (NOT!); low value  
 Additional photos: 100930 → 100933

bone.

---

180930 AU33 13.53 13.31 fd ma sl ?d shell.

---

180931 AU33 13.53 13.31 fd tw st ?d flint.

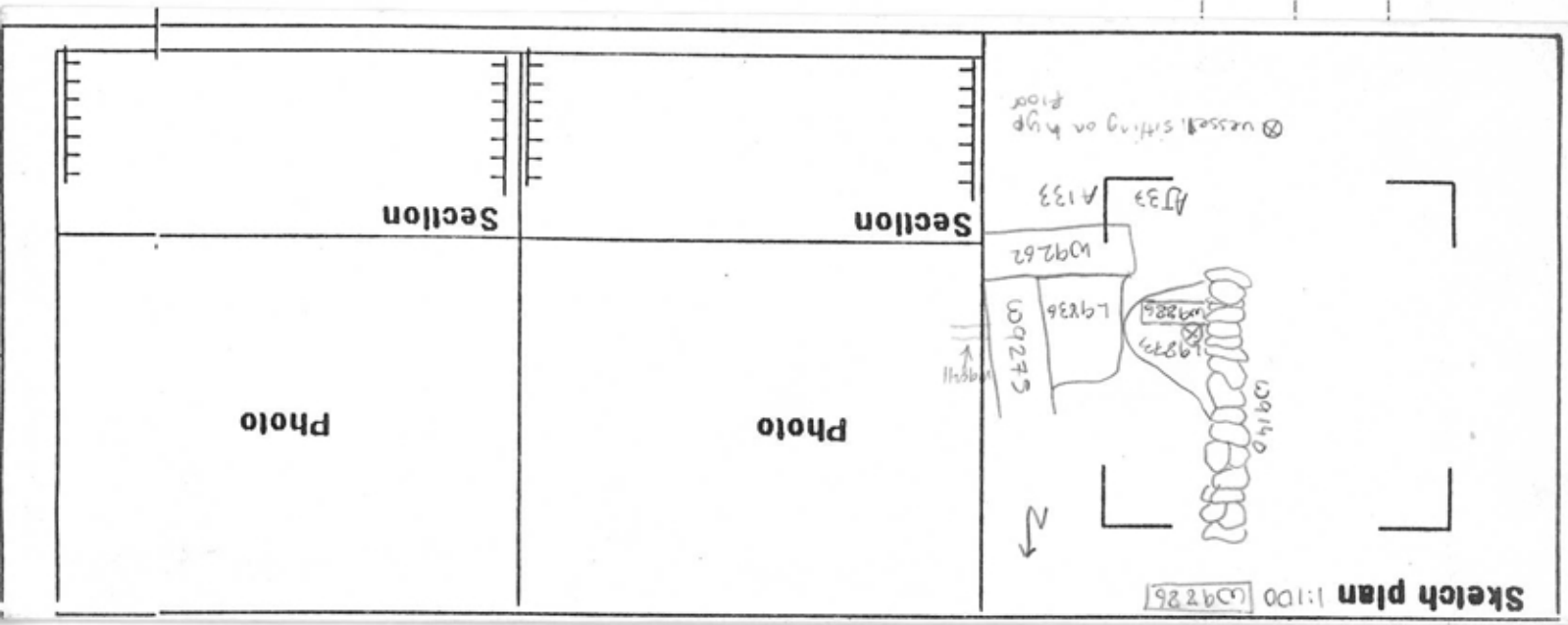

Locus W 9886	Dor 19 <sub>94</sub>	Fld G <sub>1</sub>	Sq A <sub>1</sub> J <sub>1</sub> B <sub>1</sub> C <sub>1</sub>	Loc. type Mudbrick Wall Card 2
Open Date 25/67/94	High at 13.717 W	Low at 13.46 S/E	Seals: 18067	_____
Close Date 27/67/94	13.317 W	13.311 E	Sealed by:	_____
Floor: type C <sub>1</sub> P	13.43 NW	13.214 E	Loci 9873	_____
Length 1.1	Width 1.1	Vol	above	_____
Value ?id	Remove 27/67/94	Drawn? 495	Loci 18067	_____
Photo #(1) -	Photo #(2) -		below	_____
Written by: JKS	Checked by: JBR			
Unit	Phase 87/2?	Stage	Stratum	PoM

Summary

Opened: To continue excavation and definition of wall discovered in the '93 season. Also to determine the extent of the continuation of F18021 below W9886

Limits (N) Bounded by L18040 to the North.

(S) Bounded by the previously excavated L9168 to the South.

(E) Bounded by L18040 to the East.

(W) Bounded by W9140 to the West.

Closed: Excavated wall down to level of F18021 below; wall totally removed

Matrix: Fallen mudbrick, orange and brown in color containing kurkar bits with visible fuga lines, wall damaged but visible in center of locus. The wall was so eroded that it was impossible to determine the number of courses.

Relations: New in '94 season. W9886 is reached by the material of L18040 to the North and East. Pit L9168 cuts W9886 to the South. W9886 reaches W9140 to the West. W9886 is built upon F18021, which was not traced to W9140 below W9886. W9886 covers & seals the material West of the western limit of F18021, known as L18067. The actual in situ bricks were not definable this season, so W9886 was defined as the presumed in situ material of the wall itself in the center of the locus and the mudbrick melt surrounding it.

In '93 W9886 was thought to be only a single row of stretcher bricks on what was determined in '94 to be the north edge of the wall. More fuga lines of W9886 were traced in '94 between the original north edge and pit L9168. However, the exact shape of W9886 could not be traced out very well.

Additional Observations/Value: Deteriorated mudbrick partition (?) wall built on Phase 7 Floor Medium Value.

Locus

L 918161

Sketch plan

Scale 1:100

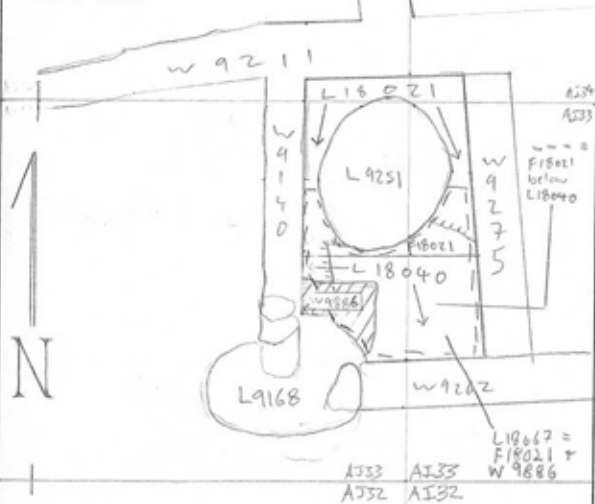

Photo

Photo

Section

Section