

Focus L 9916	Dor 19 9,3	Fld G	Sq A, 32	Loc. type Fill Material
Open 1.6/57/93	Date	High at 1.3.33 S.E	Low at 1.3.31 S.W	Seals: _____
Close 0.4/08/93		1.2.93 N	1.2.90 S	Sealed by: _____
Floor: type				Locl 9867
Length 0.9	Width 0.5	Vol		above _____
Value 4	Remove	Drawn?		below _____
Photo #(1)	Photo #(2)		Locl _____	
Written by: A.R.M	Checked by: J.R.Z		below _____	

Unit	Phase	Stage	Stratum	PoM
------	-------	-------	---------	-----

Summary

Opened: Came down on [W 9917] / Opened [L 9916] to the S and [L 9918] to the N of the wall.

Limits (N) [W 9917]

(S) Baulk

(E) Baulk

(W) [W 9913] and [W 9959]

Closed: End of the season

Matrix: Red brown material with a lot of pottery (less as we went lower), bone and mudbrick debris. [W 9917] consists of head size irregular fieldstones with under it a mudbrick pedestal. [W 9913] consists of smaller stones (might be rubble that slid down) and [W 9959] also consists of head size fieldstones

Relations: [L 9867] covers, but does not seal [L 9916].
 To the N the fill material of [L 9916] reaches the wall [W 9917]
 To the S [L 9916] appears to continue into the baulk.
 To the E the fill material of [L 9916] reaches wall [W 9959]
 To the W [L 9916] appears to continue into the baulk

Additional Observations/Value: Fill material between 2 walls

sketch plan

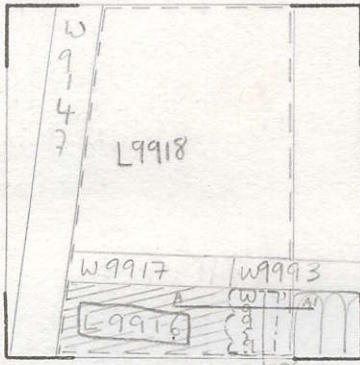

Locs above --- : L 987
 loc below --- : L 987



101263



101101

Section

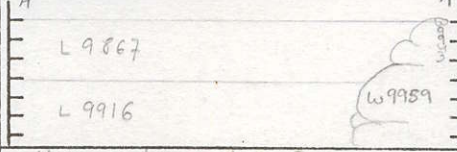

Section



View from the South

pottery- BIC						
99644	AK32	13.03	12.93	sa	ma bn	u
bone						
99657	AK32	12.92	12.92	sa	tw st	u
multicolored flint piece						