

Locus L 9927	Dor 191,3	Fld G1	Sq A133	Loc. type Mudbrick debris to floor		
Open 20/07/93	Date	High 13.32 W	at	Low 13.32 E	at	Seals: _____
Close 27/07/93		13.26 N		13.20 S		Sealed by: _____
Floor: type GP		13.26 N		13.21 N		Locl 9919 9927 9928 _____
Length 2.3	Width 1.4		Vol			above _____
Value U	Remove 1/1/1		Drawn? YES			below _____
Photo # (1) 101671		Photo # (2) 101672		Locl 9955		_____
Written by: RSD		Checked by: J.R.Z				_____

Unit	Phase	Stage	Stratum	PoM
------	-------	-------	---------	-----

Summary

Opened: L9919 came down on pit L9926 and was split into L9926, L9927 and L9928. L9927 and L9928 were only technical divisions to create a fault

Limits (N) L9926 and L9928
(S) L9844
(E) W9684
(W) W9275

Closed: Came down on fragmentary floor F9927. Changed to L9955 below F9927

Matrix: Dark brown, very dense mudbrick debris. Similar to L9919 above and L9928 to the N. Unlike brightly colored material in pit L9926 or looser brown soil in L9844 to the S. Similar to matrix in S. half of L9928, though not to the areas of looser medium brown loam or ashy soils.

Relations:

L9919 above continues down as L9927.
 To the N. L9927 continues into L9928.
 L9927 is cut to the N. and E. by pit L9926.
 L9927 reaches the second phase (from the top) of W9684 to the E., and also reaches the lower stages (and possibly earlier phase) of the socle of W9275 to the W.
 To the S. L9927 does not continue into L9844, and the relationship between the two loci is uncertain. (See matrix above)
 To the N. L9927 continues into a section of L9928, though again the relationship between the two fills is uncertain.
 F9927 appears to reach the S. edge of F9928, though the lip of F9928 clearly rises above the level of F9927. The floor does not reach any other walls.
 L9927 covers but does not seal L9955.

Additional Observations/Value: Partial floor possibly related to installation 9928; medium value; additional photos: 101673 to 101696

Sketch plan [9927] 1:100

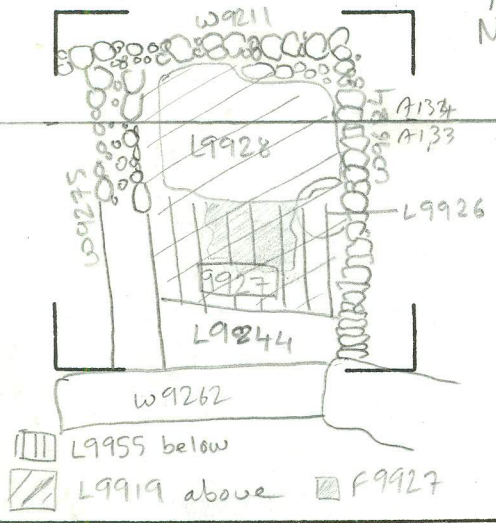

Photo

Photo

Section

Section

