

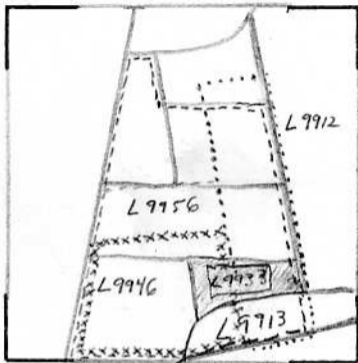



Sketch plan L9933



↑
N
1:100

-  L9895 above  L9979 below
 W9964 below

Locus <u>L 9933</u>	Dor 19 <u>93</u>	Fld <u>G</u>	Sq <u>A531</u>	Loc. type <u>Mudbrick Debris Fill</u>
Open	Date <u>21/07/93</u>	High at <u>13.75 W</u>	Low at <u>13.74 E</u>	Seals: <u> </u> <u> </u> <u> </u>
Close	<u>28/07/93</u>	<u>13.45 W</u>	<u>13.40 E</u>	Sealed by: <u>L9895</u> <u> </u> <u> </u>
Floor: type <u> </u>	Width <u> </u>	Vol <u> </u>	Drawn? <u> </u>	Locl <u>L9895</u> <u> </u> <u> </u>
Length <u>0.7</u>	Remove <u> </u>			above <u> </u> <u> </u> <u> </u>
Value <u>u</u>				Locl <u>W9964</u> <u>L9979</u> <u> </u>
Photo #(1) <u> </u>	Photo #(2) <u> </u>			below <u> </u> <u> </u> <u> </u>
Written by: <u>S.G.O</u>	Checked by: <u>J.R.Z</u>			

Unit	Phase	Stage	Stratum	PoM
------	-------	-------	---------	-----

Summary

Opened: When an area of mudbrick debris was encountered at the base of L9895, the stone rubble deposit.

Limits (N) L9956
 (S) L9913
 (E) L9912
 (W) L9946

Closed: When the top of a mudbrick wall, W9964, was encountered.

Matrix: After some initial potsherds & a few stones, a layer of pure mudbrick debris L9956 and L9913 are a continuation of this matrix. L9912, however, contains fragments of toppled mudbricks and higher sherd density than L9933. L9946 is also differentiated from L9933 in that it is a continuation of the stone rubble deposit of L9895.

Relations: L9933 is covered, but not sealed by L9895, since L9933 appears to consist of eroded mudbricks, which must have been at least partially exposed after the deposit of stone rubble was formed. To the N and S, L9956 and L9913 are respectively continuations of the eroded mudbrick matrix of L9933. To the E, L9933 is reached by L9912, an area of toppled mudbrick fragments. To the W, L9933 reaches the continuation of the stone rubble deposit, L9946. L9933 covers, but does not seal, a section of W9964, running roughly N-S. To the W, L9933 covers, but does not seal, a portion of L9979. However, L9979 is still considered to be sealed by the stone rubble deposit, L9895.

Additional Observations/Value: Although L9933 does not possess much value for stratigraphic analysis, W9964 directly underneath does.