

Locus L 9946	Dor 1993	Fld G ₁	Sq AI31	Loc. type Rubble Fill
Open 2.6/07/93	Date	High at 13.79 SW	Low at 13.66 NE	Seals: L9977
Close 28/07/93		13.48 W ₁	13.44 E ₁	Sealed by:
Floor: type				Locl L9895
Length 1.4	Width 1.7	Vol		above
Value u ₁	Remove		Drawn?	below
Photo # (1)	Photo # (2)			Locl L9979
Written by: SIGO	Checked by: JRZ			

Unit	Phase	Stage	Stratum	PoM
-------------	--------------	--------------	----------------	------------

Summary

Opened: When several areas of pure mudbrick debris were noticed at the base of L9895.

Limits (N) L9956
(S) Bulk of AI31, and the Wmost extent of W9715 in the SE.
(E) L9933 to the N, L9913 to the S.
(W) Pedestal underneath L9025, the Roman drain feature.

Closed: When S edge of W9963 and Wedge of W9964 were defined

Matrix: Continuation of fieldstone rubble debris of L9895. Field stones ranging in size from fist size to 40x40x20cm, in a matrix of mudbrick debris. Sherd density is low, but still higher than in adjacent loci of pure mudbrick debris (L9956, L9933, and L9913), which contain no inclusions.

Relations: L9946 is a continuation of the matrix of L9895 above. To the N and E, L9946 reaches three loci composed of pure mudbrick debris - L9956 to the N, L9933 to the NE, and L9913 to the SE. L9946 covers, and seals, L9979 below.

Additional Observations/Value: This locus only has value for stratigraphic analysis in that it is a continuation of L9895, the field stone wall collapse.

Locus Basket List

L 9946

Bask. No.	Sq.	Beg. Ele.	Cl. Ele.	St Df	Lc	Ma	R	C	P1
99592	A131	13.74	13.56	fs	tw st				u
stone weight?									
99607	A131	13.74	13.56	fs	sh cr 2				u ir
pottery									
99608	A131	13.74	13.56	fs	ma bn				u
bone									
99650	A131	13.56	13.39	fs	sh cr 2				u ir1
pottery									
99651	A131	13.56	13.39	fs	ma bn				u
bone									
99652	A131	13.56	13.39	fs	ma sl				u
shell									
99702	A131	13.40	13.40	fs	tw st				u
grinding basin									
99714	A131	13.39	13.39	fs	ot st				u

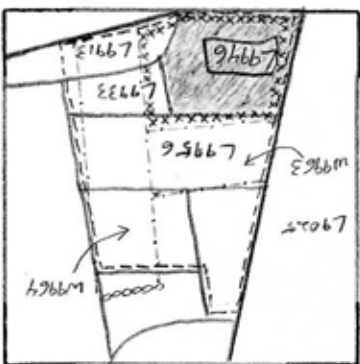

Sketch plan L9946

L9895 above
 L9779 below
 --- walls below

Section

Photo

Section

Photo