

Locus U 9950	Dor 19 93	Fld 6	Sq AH33	Loc. type FLOOR MAKEUP; FILL TO FLOOR
Open Date 27/07/93	High at 14.12 N	Low at 14.00 C	Seals: _____	
Close Date 01/08/93	13.96 N	13.93 SW	Sealed by: _____	
Floor: type C/P	13.96 N	13.93 SW	Locl 1A986	
Length 2.4	Width 2.3	Vol _____	above _____	
Value 1	Remove 1/1/1	Drawn? NOT YET	Locl UNEXCAVATED	
Photo #(1) SEE ISRA	Photo #(2) SEE ISRA		below _____	
Written by: SEB	Checked by: J.R.Z			

Unit	Phase	Stage	Stratum	PoM
Summary				

Opened: IN ORDER TO GO BELOW F9896

Limits (N) BOUNDED BY W9735

(S) BOUNDED BY W9989 AND 19899

(E) BOUNDED BY W9988 AND THE BULK WITH A633

(W) BOUNDED BY W9266

Closed: NOT CLOSED, END OF SEASON

Matrix: MODERATELY SOFT SANDY SILT; SOFTER IN SOUTH MORE COMPACT AND ROCKIER IN NORTH AS IT APPROACHES W9990. MODERATE AMOUNT OF BONE AND A DENSE CONCENTRATION OF POTTERY. SOME MUDBRICK INCLUSIONS & CHARCOAL. F9896 WAS A PARTIAL FLOOR WITH A MINIMUM OF 3 RESURFACINGS, ALL OF CRUSHED KURKAR; SOIL HAS FAR FEWER MUDBRICK INCLUSIONS THAN L9983

Relations: L9950 IS COVERED BUT NOT SEALED BY L9896, AND COVERS BUT DOES NOT SEAL UNEXCAVATED MATERIAL BELOW. L9950 REACHES W9735, W9266, W9988, AND MUDBRICK W9989. F9950 REACHES W9989, W9988, W9266 AND W9735. THE TABUN CUTS THE FLOOR, AND THE INSIDE OF THE TABUN IS FLOORED WITH THE KURKAR REACHING THE SHEETS THAT LINE THE TABUN. L9950 IS CUT BY THE TABUN L9899. THE TABUN MAY CONTINUE GOING DOWN. FURTHER EXCAVATION WILL SHOW WHETHER OR NOT THIS IS THE CASE. THE FLOOR ON THE INSIDE OF THE TABUN IS AT A LOWER LEVEL THAN THE SURROUNDING F9950.

Note 97: 'F9950' is probably actually a composite of two or more floors sloping downward from W9735 to W9989. Excavation in 97 showed that W9735 is founded on a floor at elevation 14.06 and W9989 is founded apparently on the same floor at 13.76*. The section in the east bulk showed many close resurfacings across the area of this "room" over 15 cm in thickness. The level of F9950 is between the high and low points of F18209 and probably contains mixed material due to excavating sloping floors as flat surfaces.

* This is F18209

Additional Observations/Value: HIGH VALUE DUE TO THE FLOOR WHICH REACHES SO MANY OTHER ELEMENTS IN THE ROOM.

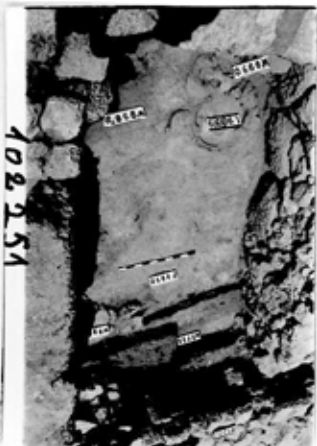

Se

Section

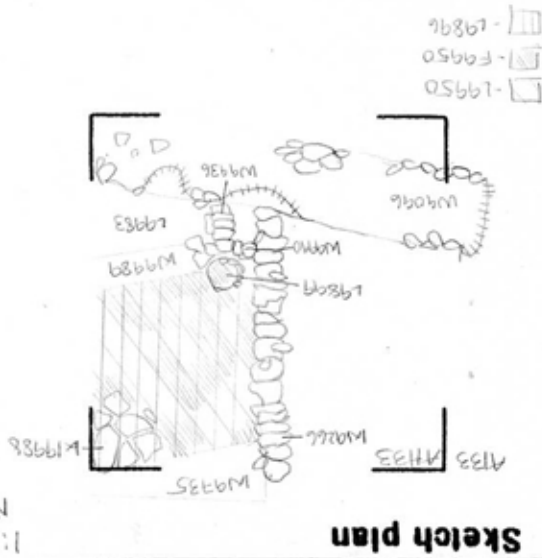

Sketch plan

1:100