

Locus W 3957	Dor 19 3,3	Flid G1	Sq A933	Loc. type RUBBLE WALL
Open	Date 12/07/93	High at 14' 8 1/2	Low at 14' 3 1/2	Seals: UN-NUMBERED PEEDESTAL
Close	03/08/93	14' 5 1/2	14' 3 1/2	Sealed by: N/A
Floor: N/A type				Locl 9932
Length 1.24	Width 0.51	Vol		above W9282
Value 11	Remove	Drawn?		Locl NONE YET
Photo #(1) 102069	Photo #(2) 102070			below
Written by: GSC	Checked by: JRZ			

Unit	Phase	Stage	Stratum	PoM
------	-------	-------	---------	-----

Summary

Opened: WHEN L9932 CAME DOWN ON W9957

Limits (N) PEEDESTAL BELOW W9282

(S) L9944, L9972

(E) L9944, L9962 AND UNEXCAVATED AREA BELOW L9962

(W) L9944, L9972 AND UNEXCAVATED AREA BELOW L9972

Closed: NOT CLOSED, END OF SEASON.

Matrix: WALL CONSISTING OF DOUBLE HEAD SIZE STONES W/ FIST SIZE CORBLES. WALL FLATS AT SOUTHERN TIP AFTER 2 COURSES AND IS PEEDESTALED ON THE ^{unnumbered} MUD BRICK WALL BELOW L9986.

Relations: L9932 COVERS, BUT DOES NOT SEAL W9957. W9957 WILL SEAL ITS UNEXCAVATED PEEDESTAL.

To the N, W9957 CLEARLY RUNS UNDERNEATH W9282, THUS W9282 IS LATER THAN W9957.

To the E, F9944 AND F9962 BOTH REACH W9957, AS DOES A THIRD FLOOR VISIBLE IN SECTION BELOW F9962.

IT IS NOT YET CLEAR HOW FAR BELOW THESE FLOORS THE FOUNDATION PART OF W9957 BEGINS. IT MAY BE FOUNDED ON THE UNNUMBERED

MUDBRICK WALL BELOW. (IN ADDITION, F9944 + F9962 WRAPPED AROUND TO TOUCH THE SPACE OF W9957)

SUGGESTING THAT AT THAT LEVEL W9957 HAD NO DRAINAGE TRENCH.

To the S, L9944 REACHES W9957 BECAUSE ITS FLOOR DID. L9972 ALSO REACHES W9957 BECAUSE

W9957'S SOUTHERN EXTENSION CONSISTING OF A FEW FIST SIZED CORBLES AND ONE HEAD SIZE CORBLE

WAS WITHIN L9972'S MATRIX. IF W9957 IS PRESERVED ONLY 2 COURSES HIGH, ITS LOWEST PART MAY BE FOUNDATIONAL AND SO CUT L9972 + 1973

To the W, L9944 REACHES W9957 (AS ABOVE), AS DOES L9972. L9972 CAME DOWN ON A

SLIGHT PATCH OF QUESTIONABLE CLOSE IN THIS AREA, WHICH DOES NOT REACH W9957

Note: THE SOUTHERN END OF W9957 IS PEEDESTALED UPON A MUD BRICK WALL THAT RUNS

ROUGHLY IN THE SAME DIRECTION AS W9957 AND EXTENDS FURTHER TO THE SE. FURTHER,

W9957 IS SIMILAR IN ORIENTATION W9936 IN AH33 AND MAKES A RIGHT ANGLE TO W9930

AND AH33. THE WALLS IN AH33 ARE AT A LOWER ELEVATION BUT ARE OF SIMILAR CONSTRUCTION. ALSO THE MUD BRICK WALL BELOW W9957 IS AT A RIGHT ANGLE W/ W9989 IN AH33.

Note F9932a is just above F9944 and may be a final resurfacing of it. F9932a may have reached upper, unpreserved courses of W9957

Additional Observations/Value: HIGH VALUE EARLY IRON AGE WALL.

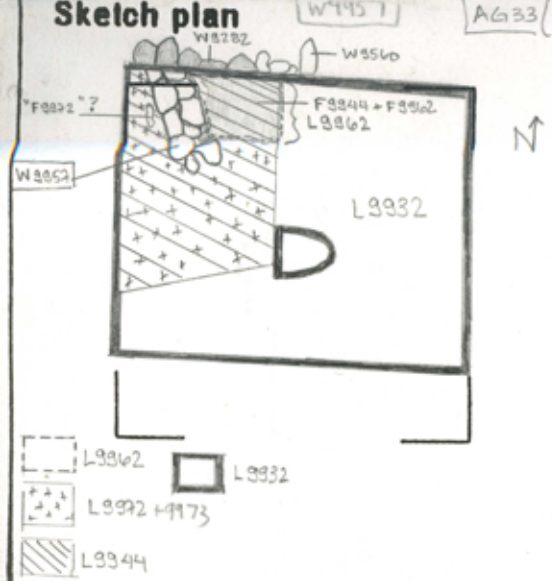

101840

Section

Sec



102069



102070



102071



102072



102219



101835

Locus <u>W 9957</u>	Dor <u>19³⁴</u>	Fld <u>G</u>	Sq <u>AG33</u>	Loc. type <u>Rubble Wall; card 2</u>					
Open <u>04/07/14</u>	Date	High at <u>14.56</u>	at <u>N</u>	Low at <u>14.30</u>	at <u>S</u>	Seals: <u>18045</u>	_____	_____	_____
Close <u>03/08/14</u>		<u>14.516</u>	<u>N</u>	<u>14.30</u>	<u>S</u>	Sealed by: _____	_____	_____	_____
Floor: type _____		_____	_____	_____	_____	Loci <u>9937</u>	_____	_____	_____
Length <u>1.7m</u>	Width <u>0.5</u>	_____	_____	Vol _____	_____	above <u>W9282</u>	_____	_____	_____
Value <u>i</u>	Remove _____	_____	_____	Drawn? <u>Y, S</u>	_____				
Photo #(1) _____		Photo #(2) _____				Loci <u>18045</u>	_____	_____	_____
Written by: <u>RSL</u>		Checked by: <u>JRZ</u>				below _____	_____	_____	_____

Unit _____	Phase _____	Stage _____	Stratum _____	PoM _____
------------	-------------	-------------	---------------	-----------

Summary _____

Opened: was in evidence from first day of excavation

Limits (N) see previous season

(S) see previous season, new limits are L18045

(E) L18043

(W) L18076

Closed: end of season, not closed

Matrix: wall consists of double head size stones with fist size cobbles. Wall floats at southern tip after 2 courses and is pedestaled on L18045.

Relations: for loci abck see card 1. W9957 seals a north central part of W18045

To the North W9957 continues below W9282.

To the East W9957 is reached by the rubble section of L18030. W9957 cuts the fill below the cobbles L18043.

To the South W9957 seals the central part of W18045 which runs under and continues south.

To the west F18076/9986/18081 (= F9657 in AH33; Cheryl's floor) is cut by W9957. L18076 is also cut by W9957. A deep bowl was stuck into F18076 where F18076 is probably cut by W9957.

The southern end of W9957 is pedestaled upon W18045 which continues south. W18045 may intersect with W9989 which became evident with the excavation of the balk. The possible intersecting wall W9989 should be investigated further next season.

Note that F18000/F18006 was seen in one continuous line in the balk below W9278 at the S end of AG33. This shows that W9957 never reached this far south.

Additional Observations/Value: High Value early Iron age wall

see Locus card L9957 1993 for further information.

Locus

4 9957

L18043

Sketch plan

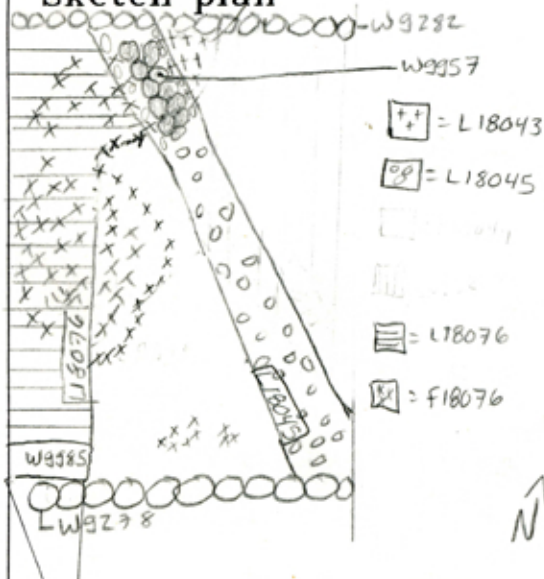

Photo

Section

AH/A633 Balk

Note that plan is very much not to scale.