

Locus <u>L 9958</u>	Dor 19 <u>93</u>	Fld <u>G</u>	Sq <u>A, K, 32</u>	Loc. type <u>deposit under pavement</u>
Open <u>2, 8, 07, 93</u>	Date	High at <u>13.5.5 S</u>	Low at <u>13.4.2 C</u>	Seals: <u>_____</u>
Close <u>04/08/93</u>		<u>13.4.1 E</u>	<u>13.1.7 W</u>	Sealed by: <u>9942</u>
Floor: type <u>clf</u>		<u>13.5.3 N</u>	<u>13.4.6 S</u>	Locl <u>9942</u>
Length <u>2.0</u>	Width <u>0.7</u>	Vol <u>_____</u>		above <u>_____</u>
Value <u>1</u>	Remove <u>04/08/93</u>	Drawn? <u>YFS</u>		below <u>_____</u>
Photo #(1) <u>102041</u>	Photo #(2) <u>102042</u>			Locl <u>9995.5?</u>
Written by: <u>A. GH</u>	Checked by: <u>JRZ</u>			below <u>_____</u>

Unit	Phase	Stage	Stratum	PoM
------	-------	-------	---------	-----

Summary

Opened: Took out pavement of L9942

Limits (N) L 9987 and L 9931
 (S) L 9891 and L 9977
 (E) Western limit of square 1732
 (W) L 9918, L 9925, L 9924 and L 9935
 Closed: End of season, and came down on 2-3 cm layer of ash over most of area of L9958

Matrix: under pavement first brown, sandy material with small stones, smashed pottery (pithos) and on the bottom a thick sloping ash layer. Small fragments of floor (very thin and white) on the highest part of the locus (E). L 9987 brown sandy material L 9991 pit material: brown sandy with a lot of pottery and bone L 9977 brown sandy material

Relations: Continuation of matrix: L 9918 greyish in the N and red-brown in the S L 9920 and L 9925 red-brown L 9925 greyish material
 Relations: L 9942 seals L 9958, L 9958 covers but does not seal L 9995*
To the N L 9958 continues into L 9987 since the floor fragments of L 9958 extend into L 9987, L 9931 might reach the ash layer of L 9958 and L 9958 above it
To the S L 9958 is cut by the pit L 9891 and probably continues into the fill material of L 9991
To the W L 9958 may be reached by L 9918, L 9925, L 9924 and L 9925
but this relation is not certain
To the E L 9380 of square 1732 might be a continuation of L 9958 (cl. 13.80-13.33)
The locus consists of layers of brown sandy soil, ashy soil and charcoal and plaster floors. The elev of the floor is 13.51-13.60 it might be a continuation of Floor L 9958 where more residues were visible. This is also the case for the fragmentary floors of L 9380
* because the L 9958 was narrow and sinuous. The ash material at the bottom of L 9991 (where L 9958 is not preserved) covers and likely seals the unexcavated and unnumbered locus below. The ash layer at the bottom of L 9958 extends into L 9931, L 9987 and L 9995. In about the center of L 9958 was a lense of pithos body sherds which looked in situ; this is odd since no rim, handle or base was evident
L 9958 only reaches W 9992. It is not clear what cut L 9958 to the W. To the S it is cut by pit L 9891. To the E it may

Additional Observations/Value: Sealed deposit under pavement with thick ash layer at bottom
 Additional Photos: 102043-102049

continues into L 9380

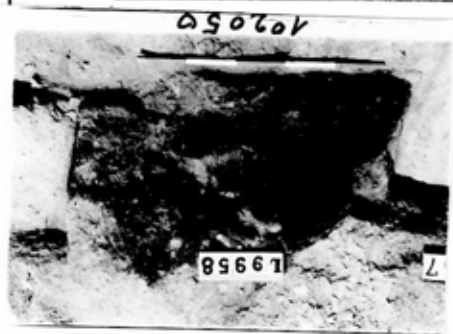

L 9912
 L 9924 and L9925 (below L 9912)
 L 9935
 L 9935
 L 9935
 L 9942
 floor L 9958
 L 9958
 XXXX ash layer L 9958

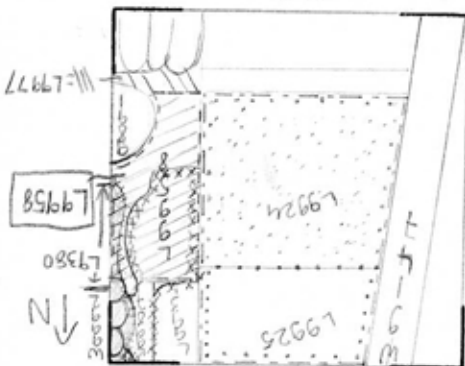

Sketch plan L9958

Section

Section