

Locus L 9967	Dor 19 9.3	Fld 91	Sq A.32	Loc. type Fill (Below floor?)
Open Date 29/07/93	High at 12.57 NW	Low at 12.85 SE	Seals: _____	
Close Date 30/07/93	12.612 NW	12.511 SE	Sealed by: _____	
Floor: type 1	Width 2.1	Vol	Locl L9947	
Length 2.1	Remove 1/1/1	Drawn? _____	above _____	
Photo # (1) _____	Photo # (2) _____		Locl 18242 18250 18230	
Written by: CWR	Checked by: J.R.Z		below _____	

Unit _____	Phase 9	Stage _____	Stratum _____	PoM _____
------------	---------	-------------	---------------	-----------

**Summary**

**Opened:** Excavation in L9947 and L9900 came down on F9947. [L9967] opened to excavate unsealed part of L9947

**Limits (N)** W9909 and [L9908]

**(S)** bank

**(E)** W9140

**(W)** L9900

**Closed:** at end of season - Not closed.

**Matrix:** (Continuation of L9947). Mottled orange, brown, gray and black matrix of SE corner phases out with further excavation. Matrix consists of medium-brown sandy soil with very few sherds, shell, and bone; mud brick material.

**Relations:** [L9967] is covered, but not sealed by L9947. [L9967] covers, but does <sup>not</sup> seal an unexcavated locus below [L9967], L9947 and the material below [L9967] seem to be one continuous deposit.

To the N: [L9967] probably reaches W9909. No floor reaching W9909 was found in L9947 above or in [L9967], suggesting that W9909 is here superstructures.

To the E: [L9967] continues below L9947 below W9140.

To the S: [L9967] continues into the S bank.

To the W: [L9967] may continue below F9947, but this is uncertain until F9947 and the fill below are excavated. [L9967] may continue into the S part of L9908 but further excavation in the area of L9908 is necessary to test this out.

**Note:** L9947 (above L9967) and L9967 contain a light grey lens of material sloping down from E-W. This was not noticed during excavation, but only in section. It may be leveling material for F9900 above.

**Additional Observations/Value:** Not sealed; not obviously disturbed; no goodies; rather boring.



Photo

Section

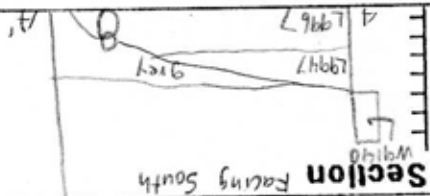

Sketch plan of L9967 Not to scale

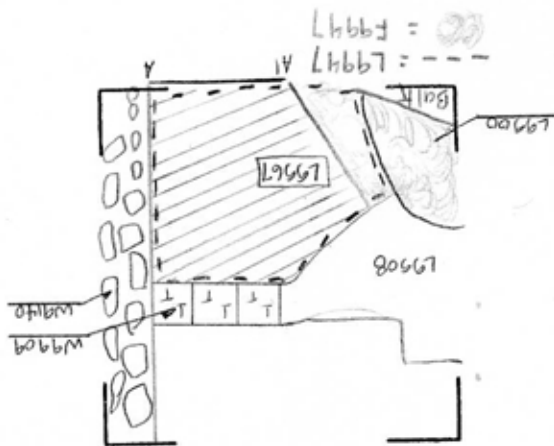

L 9967

St Lc

Df St Ob Ma R C P1 P2 P3

1 sa sh cr 2 s ir1  
agment

1 sa ma bn s

sa ma sl s

sa sh cr 2 n ir1

sa ma bn n

sa tw st n