

Locus L 9979	Dor 1993	Fld G	Sq A, J, I	Loc. type Fill to Floor
Open Date 02/28/93	High at 13.48 W	Low at 13.39 E	Seals: _____	_____
Close Date 04/08/93	13.29 S, E	13.25 NE	Sealed by: L9946	_____
Floor: type CIP	13.35 E	13.27 W	Locl L9946	L9933 L9913
Length L.S.	Width 2.1	Vol _____	above _____	_____
Value S	Remove 1/1/1	Drawn? N, Q	Locl _____	_____
Photo #(1) See Ezra	Photo #(2) _____	Locl _____	below _____	_____
Written by: S, G, O	Checked by: J, R, Z	Locl _____	below _____	_____

Unit	Phase	Stage	Stratum	PoM
------	-------	-------	---------	-----

Summary

Opened: When the base of the stone rubble deposit of L9946 was reached.

Limits (N) W9963
(S) Bank in the SW, W9715 in the SE
(E) W9964
(W) Pedestal underneath L9025 the Roman drain feature.

Closed: End of season, not closed. The top elevations of a floor (F9979) was encountered in the E of L9979. At the end of season, the extent of this floor had yet to be determined.

Matrix: Mudbrick debris, with some shards + fist to head sized stones, and some shell + bone. Also, sandy patches associated with stones. Sherd density increases with depth and closer to W9963 and W9964.

Relations: L9979 is covered primarily by, and probably sealed by, L9946, the continuation of the stone rubble deposit. To the NE, L9979 is covered by L9933, and to the SE, L9979 is covered by L9913. To the N, L9979 reaches W9963. To the E, L9979 reaches W9964. To the SE, L9979 reaches W9715. L9979 covers unnumbered and unexcavated material below. F9979 did not have any relations with adjacent loci (W9963, W9964, and W9715) by the end of the '93 season. L9979 extends W into pedestal below L9025.

NOTE: In an attempt to determine whether F9979 was partial, or continued underneath additional fill, a probe was opened in the W half of L9979. The fastest #s from this probe are 160152-160155. The continuation of F9979 was not found by the end of season at the base of this probe, but no soil change was noticed either. Thus, the extent of F9979 could not be determined by the end of the season. The closing elevations of the probe are 13.19 (NW) and 13.17 (SW). Material from this probe can be assigned to a different locus in the future, if it is determined that F9979 is indeed partial, and that this probe contains material below floor level.

Additional Observations/Value: Value is high, due to F9979.

Photo



Section

Section

3.38 13.25 sa ma mt s

3.29 13.17 sa sh cr 2 s iri
re piece.

3.29 13.17 sa ma bn s

3.29 13.17 sa ma sl s

3.29 13.17 sa ma st s
prt?

Sketch plan L9979

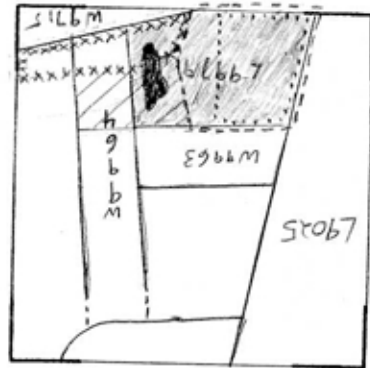

L9933 Above

L9946 above

L9913 Above

Area of probe L9979. F9979