

Locus W 9988	Dor 19 <u>93</u>	Fld <u>G</u>	Sq <u>AH33</u>	Loc. type <u>POSSIBLE PAVEMENT</u>
Open <u>03/08/93</u>	Date	High at <u>1A.11 N/W</u>	Low at <u>1.3.98 S</u>	Seals: <u> </u> <u> </u> <u> </u> <u> </u>
Close <u>06/08/93</u>		High at <u>1.3.94 N</u>	Low at <u>1.3.93 S</u>	Sealed by: <u> </u> <u> </u> <u> </u> <u> </u>
Floor: type <u> </u>		High at <u> </u>	Low at <u> </u>	Locl <u>L1896</u> <u> </u> <u> </u> <u> </u> <u> </u>
Length <u>L.0</u>	Width <u>0.8</u>	Vol <u> </u>	Drawn? <u>ND</u>	above <u> </u> <u> </u> <u> </u> <u> </u>
Value <u> </u>	Remove <u> </u> <u> </u> <u> </u>			Locl <u>UNEXCAVATED</u> <u> </u> <u> </u> <u> </u> <u> </u>
Photo #(1) <u>SEE ISRA</u>	Photo #(2) <u>SEE ISRA</u>			below <u> </u> <u> </u> <u> </u> <u> </u>
Written by: <u>SEB</u>	Checked by: <u>JRZ</u>			

Unit	Phase	Stage	Stratum	PoM
------	-------	-------	---------	-----

Summary

Opened: AT THE DISCOVERY OF A POSSIBLE WALL UNDER L986

- Limits (N)** BOUNDED BY W9735
- (S)** BOUNDED BY L9950
- (E)** BOUNDED BY BULK WITH A633
- (W)** BOUNDED BY L9950

Closed: NOT CLOSED - END OF SEASON.

Matrix: 10 RELATIVELY FLAT STONES RANGING FROM 20cm ACROSS TO 55cm. THEY ARE ONLY ONE COURSE HIGH AT THIS TIME. #9896 WAS ADHERED DIRECTLY TO THE SURFACE OF THOSE STONES TO THE FARN/W.

Relations: W9988 IS COVERED AND PARTIALLY SEALED BY THE FLOOR OF L9896. IT IS REACHED BY L9950. THE RELATIONSHIP BETWEEN F9950 AND W9988 IS UNCLEAR. IT IS ALSO UNCLEAR WHETHER W9988 ABUTS W9735 OR POVERTAILS WITH IT. IT IS POSSIBLE THAT W9735 IS, IN PART, FOUNDED ON W9988. ONLY WITH THE REMOVAL OF W9735 WILL THIS BE CLEAR. W9988 CONTINUES INTO THE BULK WITH A633.
AT THE END OF THE SEASON W9988 IS ONLY ONE COURSE HIGH AND THE BOTTOM OF THAT HASN'T YET BEEN EXPOSED.

Additional Observations/Value: POTENTIALLY HIGHLY VALUABLE. FURTHER EXCAVATION WILL REVEAL THE NUMBER OF COURSES, IF THERE ARE MORE AND WHETHER THIS IS A PAVEMENT STRUCTURE OR THE BEGINNINGS OF A WALL.

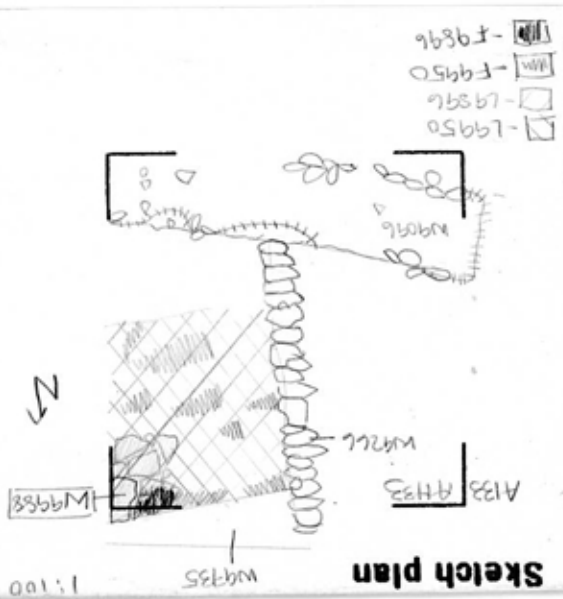
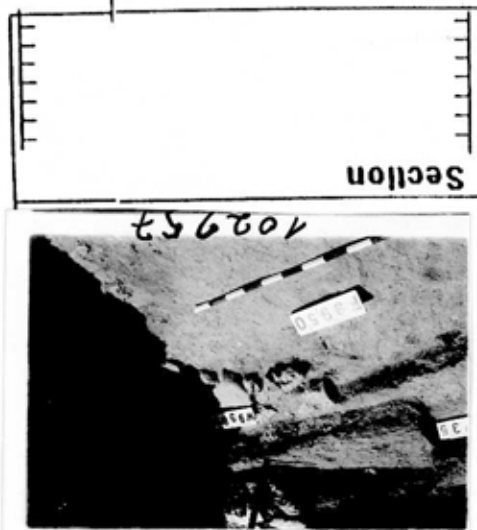

Locus W 9988	Dor 1997	Fld G ₁	Sq A1H134	Loc. type POSSIBLE PAVEMENT
Open 03/07/97	High at 14.04 W	Low at 13.99 E	Seals: _____	
Close 17/07/97	High at 13.72 W	Low at 13.70 S	Sealed by: _____	
Floor: type _____	Length 1.0	Width 0.8	Vol _____	Loci SEE 1993 LOCUS CARD
Value _____	Remove 17/07/97	Drawn? YES	above _____	
Photo # (1) SEE PREVIOUS CARD	Photo # (2) SEE PREVIOUS CARD	Loci 18247 18209		
Written by: MMS	Checked by: JRZ	below _____		

Unit _____	Phase _____	Stage _____	Stratum _____	PoM _____
-------------------	--------------------	--------------------	----------------------	------------------

Summary _____

Opened: SEE 1993 LOCUS CARD

Limits (N) BALK
 (S) L18209
 (E) L18209
 (W) BALK

Closed: W9988 WAS FLOATING AND WE WANTED TO SEE THE RELATION OF F18209 TO W9988.

Matrix: SEE 1994 LOCUS CARD. "Wall" clearly ONLY ONE COURSE high.

Relations: SEE 1993 LOCUS CARD.
 S&E: AS L18209 AND F18209 WERE NOT EXCAVATED PROPERLY, THE RELATION IS UNCERTAIN BETWEEN W9988 AND L18209. HOWEVER, THE ELEVATION OF F18209 IS 14.06^N-13.7^SM. WITH A HORIZONTAL TWILIGHT ZONE EXTENDING TO 14.11-13.71M. THIS MAY INDICATE THAT F18209 REACHED W9988. L18209 WAS PROBABLY CUT BY W9988.
 LOCUS BELOW: AS WITH THE S&E RELATIONS WITH L18209, L18247 WAS PROBABLY CUT BY W9988.

See card for 18209 for discussion of F9896, F9950 and F18209.

Additional Observations/Value: SEE 1993 LOCUS CARD

Locus
W 9988

Sketch plan



166221

Photo



166220



166219

Photo

Section



Section

