

Locus W 9989

Dor 19 93

Fld G

Sq A#23

Loc. type MUDBRICK WALL

Open Date 03/08/93 High at LA.2A E Low at LA.2D S/E
 Close 06/08/93 L4.02 N L4.00 C
 Floor: type L Width 2.4 Vol [diagram] Drawn? NOT YET
 Value L Remove [diagram]

Seals: [diagram]
 Sealed by: [diagram]
 Loc above LA 896 [diagram]
 below [diagram]

Photo # (1) 102087 Photo # (2) 102088

Loc UNEXCAVATED

Written by: SAR Checked by: JRZ

Unit	Phase	Stage	Stratum	PoM

Summary

Opened: WHEN MUDBRICK MATERIAL WAS REACHED BELOW L9896 AND FLUA LINES COULD BE SEEN IN THE BULK SECTION

- Limits (N) BOUNDED BY L9950 AND L9896
- (S) BOUNDED BY L9983, L9897
- (E) BOUNDED BULK WITH A633
- (W) BOUNDED BY W9990

Closed: NOT CLOSED - END OF SEASON

Matrix: 4 MUDBRICK TRACER BRICKS ARE EVIDENT ALONG THE NORTH EDGE AS WELL AS OTHERS IN THE BULK WITH A633. THERE IS ADDITIONAL MUDBRICK AS WELL, BUT NO FURTHER TRACEABLE MUDBRICKS. WALL MAKEUP CONTAINED SOME POTTERY AND FLINT DEBITAGE, BUT LITTLE BONE. IT SEEMS TO BE ONLY 1-2 MUDBRICKS HIGH. NORTH FACE NOT

Relations: THOROUGHLY DEFINED THIS SEASON

RELATIONS: [W9989] IS COVERED BUT NOT SEALED BY [L9896]. IT COVERS AND SEALS UNEXCAVATED MATERIAL BELOW. [W9989] IS REACHED BY [F9896], [F9897] AND [L9897]. THE RELATIONSHIP BETWEEN [W9989] AND [W9990] REMAINS UNCLEAR. IT COULD BE THAT [W9989] IS A CONTINUATION OF [W9990] ~ THEY ARE RUNNING AT THE SAME ANGLE AND THE MOST WESTERN TRACER BRICK APPEARS TO BE WEDGED IN BETWEEN TWO STONES ALIGNED WITH [W9990]. THIS IS TO THE EAST OF WHERE [W9990] MAKES A CORNER WITH [W9936]. FURTHER EXCAVATION MAY CLARIFY THIS. [W9989] FLOATS ABOVE A RESURFACING OF [F9896], WHICH IS AT THE SAME ELEVATION AS [F9983]. [W9989] CONTINUES INTO THE BULK WITH A633.

In the E bulk it was clear that [W9989] was preserved, at least to some extent, immediately below Cheryl's Famous Floor (F9657). While excavating L9896 it was impossible to establish any face of W9989 until L9896 had been taken down ca. 20 cm. Thus L9896 includes probably remnants of 1-2 course of [W9989] in its matrix

Matrix: 4 MUDBRICK TRACER BRICKS ARE EVIDENT ALONG THE NORTH EDGE AS WELL AS OTHERS IN THE BULK WITH A633. THERE IS ADDITIONAL MUDBRICK AS WELL, BUT NO FURTHER TRACEABLE MUDBRICKS. WALL MAKEUP CONTAINED SOME POTTERY AND FLINT DEBRIS, BUT LITTLE BONE. IT SEEMS TO BE ONLY 1-2 MUDBRICKS HIGH. NORTH FACE NOT

Relations: THOROUGHLY DEFINED THIS SEASON.

RELATIONS: [W9989] IS COVERED BUT NOT SEALED BY [L9896]. IT COVERS AND SEALS UNEXCAVATED MATERIAL BELOW. [W9989] IS REACHED BY [F9896], [F9897] AND [L9897]. THE RELATIONSHIP BETWEEN [W9989] AND W9990 REMAINS UNCLEAR. IT COULD BE THAT [W9989] IS A CONTINUATION OF [W9990] ~ THEY ARE RUNNING AT THE SAME ANGLE AND THE MOST WESTERN TRACER BRICK APPEARS TO BE WEDGED IN BETWEEN TWO STONES ALIGNED WITH [W9990]; THIS IS TO THE EAST OF WHERE [W9990] MAKES A CORNER WITH [W9936]. FURTHER EXCAVATION MAY CLARIFY THIS. [W9989] FLOATS ABOVE A RESURFACING OF [F9896] WHICH IS AT THE SAME ELEVATION AS [F9983]. [W9989] CONTINUES INTO THE BULK WITH A633.

In the E bulk it was clear that [W9989] was preserved at least to some extent immediately below Cheryl's Famous Floor (F9657). While excavating L9896 it was impossible to establish any face of W9989 until L9896 had been taken down ca. 20 cm. Thus L9896 includes probably remnants of 1-2 course of [W9989] in its matrix.

* NOTE - L9896 BOTH COVERS AND REACHES W9989 BECAUSE THE WALL ONLY SEEMED TO BE DEBRIS FOR A FEW CM. THE TOP HAD TO BE REMOVED UNTIL INDIVIDUAL BRICKS COULD BE MADE OUT

Additional Observations/Value: HIGH VALUE. VERY DIFFICULT TO TRACE INDIVIDUAL MUDBRICKS HORIZONTALLY AND MUCH OF THE ORIGINAL HEIGHT CAN ONLY BE SEEN IN THE BULK SECTION. FOR ADDITIONAL PHOTOS SEE ISRA.

Sketch plan

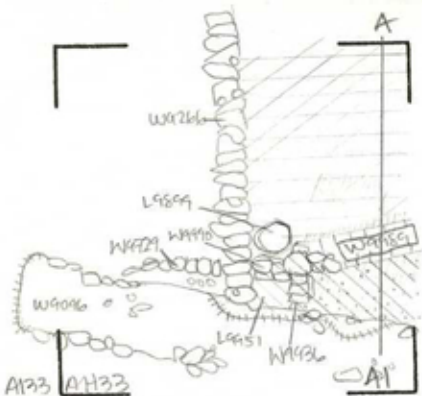

- L9983
- L9897
- L9950
- L9896
- FLOOR



102088



102229

Section Facing East

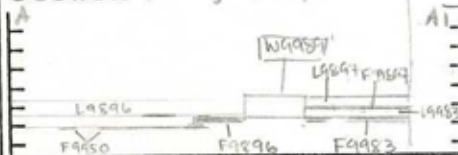

Section

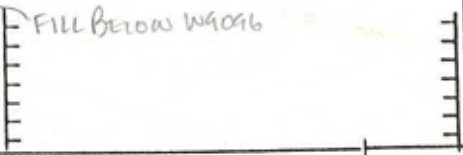

102243



102242

Locus W 9989	Dor 19 ₃₄	Fld <u>G</u>	Sq <u>AH1/AG33</u>	Loc. type <u>mudbrick wall</u>
Open	Date <u>02/08/94</u>	High at <u>14.18</u>	Low at <u>14.18</u>	Seals: <u> </u> <u> </u> <u> </u> <u> </u>
Close	<u>02/08/94</u>	<u>14.18</u>	<u>14.18</u>	Sealed by: <u> </u> <u> </u> <u> </u> <u> </u>
Floor: type <u>—</u>	Length <u>0.6</u>	Width <u>0.4</u>	Vol <u>—</u>	Loci <u>18076</u> <u> </u> <u> </u> <u> </u> <u> </u>
Value <u>—</u>	Remove <u>—/—/—</u>	Drawn? <u>NO</u>		above <u> </u> <u> </u> <u> </u> <u> </u>
Photo #(1) <u>—</u>	Photo #(2) <u>—</u>			Loci <u> </u> <u> </u> <u> </u> <u> </u>
Written by: <u>RJR</u>	Checked by: <u>JRZ</u>			below <u> </u> <u> </u> <u> </u> <u> </u>

Unit <u>—</u>	Phase <u>—</u>	Stage <u>—</u>	Stratum <u>—</u>	PoM <u>—</u>
---------------	----------------	----------------	------------------	--------------

Summary —

Opened: To continue [9989] into AG33. [18076] came down on W9989 in AG33 at the
same time as [18076].

Limits (N) L18076 and unnumbered debris below [18076]

(S) debris below [W9278]

(E) L9986

(W) continues into AH33

Closed: End of season, not closed

Matrix: mudbrick tracer bricks. clearly defined from the floor of L18076.
The floor of 18076 reached [L9989]

Relations: L18076 covers but does not seal [W9989]

To the north [L9989] reaches to L18076, f18076 reaches W9989

To the south [L9989] continues into the debris beneath W9278

To the east [L9989] continues into ends at L9986. f18076/f9986/f18081

seem's to reach W9989 but this relation is less clear here because of the poor condition of

f18076 here. To the west [L9986] W9989 continues into AH33

As L18076 was being excavated a mudbrick wall which directly corresponds
with AH33 was uncovered.

[W9989] was not recognized as such when L18076 came down on it and so W9989 was
excavated a bit below the level of F18076; however, F18076 clearly sloped up and

[W9989] was not recognized as such when L18076 came down on it and so W9989 was excavated a bit below the level of F18076; however, F18076 clearly sloped up and reached [W9989]. [W9989] with [W18045] seem to form a door way into the area of Cheryl's famous floor.

Additional Observations/Value: The value of [L9989] is high as it could belong to an intersecting wall of L18045. Thus establishing the perimeter of a room or courtyard.

LOCUS

Y 99.89

Sketch plan

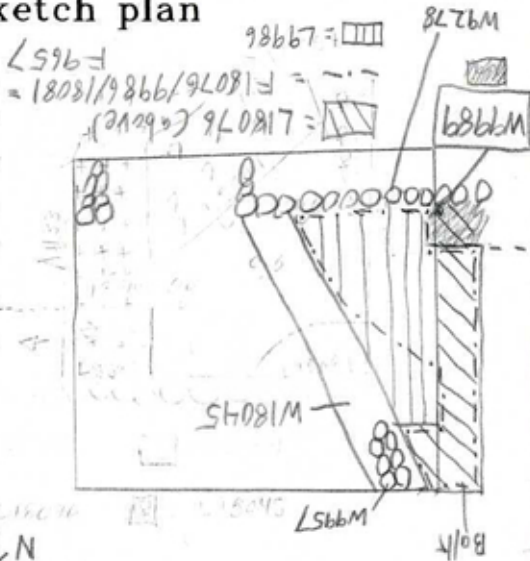

Locus W 9989 Dor 1997 Fld G1 Sq A143311111 Loc. type MUDBRICK WALL

Open Date 03/17/97 High at 14.04 E1 Low at 14.03 W1 Seals: |||| |||| |||| ||||
Close 12/08/97 High at 13.79 N1 Low at 13.76 W1 Sealed by: |||| |||| |||| ||||
Floor: type 1.2 Width 0.4 Vol 1.2 Loci |||| |||| |||| ||||
Value 11 Remove 1/1/1 Drawn? YES above |||| |||| |||| ||||

Photo #(1) 166293 Photo #(2) 166296 Loci 18209 |||| |||| |||| ||||
Written by: MAS Checked by: JRZ below |||| |||| |||| ||||

Unit Phase Stage Stratum PoM

Summary

Opened: SEE PREVIOUS LOCUS CARD

- Limits (N) SEE PREVIOUS LOCUS CARD AND L18209
- (S) SEE PREVIOUS LOCUS CARD AND L18253, F18253
- (E) SEE PREVIOUS LOCUS CARD
- (W) SEE PREVIOUS LOCUS CARD AND W9990

Closed: END OF SEASON; NOT CLOSED.

Matrix: SEE PREVIOUS LOCUS CARD. ALSO, DARK BROWN MUDBRICKS BELOW TRACER BRICKS.

Relations: SEE PREVIOUS LOCUS CARD.

N: W9989 IS REACHED BY L18209. W9989 IS BUILT ON TOP OF F18209. THIS IS A DIFFERENT ^{floor} THAN F9896 AS ORIGINALLY THOUGHT. FOR A FULL DISCUSSION SEE L18209 CARD.

W: W9989 ABUTS W9990. THE MUDBRICK OF W9989 IS SEEN curving up ^{and fill below} WHERE ABUTTING W9990.

S: W9989 IS PROBABLY REACHED BY L18253, FLOOR MAKEUP ^{and fill below} OF L9983. THERE IS A GREY ASHY FLOOR THAT REACHES W9989 THAT IS PROBABLY F18253. This F18253 was seen only once a section was excavated through W9989 from north to south, only a narrow fragment of F18253 was found adhering (i.e. reaching) the south face of W9989.

Relations: SEE PREVIOUS LOCUS CARD.

N: [W9989] IS REACHED BY L18209. [W9989] IS BUILT ON TOP OF F18209. THIS IS A DIFFERENT ^{floor} THAN F9890 AS ORIGINALLY THOUGHT. FOR A FULL DISCUSSION SEE L18209 CARD.

W: [W9989] ABUTS [W9990]. THE MUDBRICK OF [W9989] IS SEEN curving up ^{and} ~~down~~ ^{where} ABUTTING W9990.

S: [W9989] IS PROBABLY REACHED BY L18253, FLOOR MAKEUP ^{and fill below} OF L9983. THERE IS A GREY ASHY FLOOR THAT REACHES [W9989] THAT IS PROBABLY F18253. This [F18253] was seen only once a section was excavated through W9989 from north to south, only a narrow fragment of F18253 was found adhering (i.e. reaching) the south face of [W9989].

Additional Photos: 166745-166746A

Additional Observations/Value: HIGH VALUE; ^{IR} MUDBRICK WALL POSSIBLY INTERSECTING WITH MANY FEATURES.



166748



166750



167499



1674891

Locus

W 19989

Sketch plan



166293



166296

Locus
W 9989



1674891

Sketch plan



166293



166296

Section



166746



166746A

▨ = W9989

▨▨ = F18253



166745

Locus W 9989	Dor 1997	Fld G ₁	Sq A14331111	Loc. type MUDBRICK WALL
Open Date 0.3/07/97	High at 1.4-0.4 E1	Low at 1.4-0.3 W1	Seals: 1111 1111 1111 1111	
Close 1.2/08/97	1.3-7.9 N1	1.3-7.6 W1	Sealed by: 1111 1111 1111 1111	
Floor: type 1	Length 1.3	Width 0.4	Vol 1.1	Loci SEE PREVIOUS LOCUS CARD
Value 11	Remove 1/1/1	Drawn? YES	above 1111 1111 1111 1111	
Photo #(1) 166293	Photo #(2) 166296	Loci 18209	below 1111 1111 1111 1111	
Written by: MAS	Checked by: J.R.2			
Unit	Phase	Stage	Stratum	PoM

Summary

Opened: SEE PREVIOUS LOCUS CARD

Limits (N) SEE PREVIOUS LOCUS CARD AND L18209

(S) SEE PREVIOUS LOCUS CARD AND L18253, F18253

(E) SEE PREVIOUS LOCUS CARD

(W) SEE PREVIOUS LOCUS CARD AND W9990

Closed: END OF SEASON; NOT CLOSED.

Matrix: SEE PREVIOUS LOCUS CARD. ALSO, DARK BROWN MUDBRICKS BELOW TRACER BRICKS.

Relations: SEE PREVIOUS LOCUS CARD.

N: W9989 IS REACHED BY L18209. W9989 IS BUILT ON TOP OF F18209. THIS IS A DIFFERENT^{floor} THAN F9896 AS ORIGINALLY THOUGHT. FOR A FULL DISCUSSION SEE L18209 CARD.

W: W9989 ABUTS W9990. THE MUDBRICK OF W9989 IS SEEN CURVING UPGLANDERE ABUTTING W9990

S: W9989 IS PROBABLY REACHED BY L18253, FLOOR MAKEUP^{and fill below} OF L9983. THERE IS A GREY ASHY FLOOR THAT REACHES W9989 THAT IS PROBABLY F18253. THIS F18253 WAS SEEN ONLY ONCE a section was excavated through W9989 from north to south, only a narrow fragment of F18253 was found adhering (i.e. reaching) the south face of W9989.

Additional Photos: 166745-166746A
Additional Observations/Value: HIGH VALUE; MUDBRICK WALL POSSIBLY INTERSECTING WITH MANY FEATURES.



166748



166750



1674891

Locus

W 9989

Sketch plan



L1826

L18209

L9987

L9989

L18253

W 9926

W 9978



166293



166296

Section



166746



166746A

▨ = W 9989

▨ = F18253



166745